

# A-B-A-C-U-S

WEST HAMPSTEAD

## Shenley Road, Borehamwood, WD6

The Crown is a brand new development of apartments available on the HELP TO BUY located moments away from Elstree & Borehamwood Thameslink station. This two bedroom apartment has been carefully designed to offer bright and spacious living space with all the modern features you would expect in a brand new home, including gas fired central heating, grey luxury fitted carpets to bedrooms, Sky T.V points and Amtico flooring to reception and kitchen areas. The property boast contemporary handle less kitchens, with matching Corian work surfaces and a range of integrated appliances. Whilst bathrooms are both modern and sleek with stylish wall hung hand basins with large mirrors above, tiled enclosed baths with fitted shower screens and separate thermostatically controlled showers, as well as under floor heating.



**£365,000 Leasehold**

303 WEST END LANE • WEST HAMPSTEAD • LONDON NW6 1RD

T: 020 7431 3777 • E: WESTHAMPSTEAD@ABACUSESTATES.COM • W: ABACUSESTATES.COM

ABACUS ESTATES IS A TRADING NAME FOR AND ON BEHALF OF ABACUS ESTATES (LONDON) LIMITED NO: 099182841 • VAT REGISTRATION NO: 223 0774 34 • REGISTERED OFFICE: 103 CHAMBERLAYNE ROAD, LONDON, NW10 3NS



Energy Efficiency Rating		Current	Potential
Very energy efficient - lower running costs			
(92-100)	A		
(81-91)	B		
(69-80)	C		
(55-68)	D		
(39-54)	E		
(21-38)	F		
(1-20)	G		
Not energy efficient - higher running costs			
England, Scotland & Wales		EU Directive 2002/91/EC	

Environmental Impact (CO <sub>2</sub> ) Rating		Current	Potential
Very environmentally friendly - lower CO <sub>2</sub> emissions			
(92-100)	A		
(81-91)	B		
(69-80)	C		
(55-68)	D		
(39-54)	E		
(21-38)	F		
(1-20)	G		
Not environmentally friendly - higher CO <sub>2</sub> emissions			
England, Scotland & Wales		EU Directive 2002/91/EC	



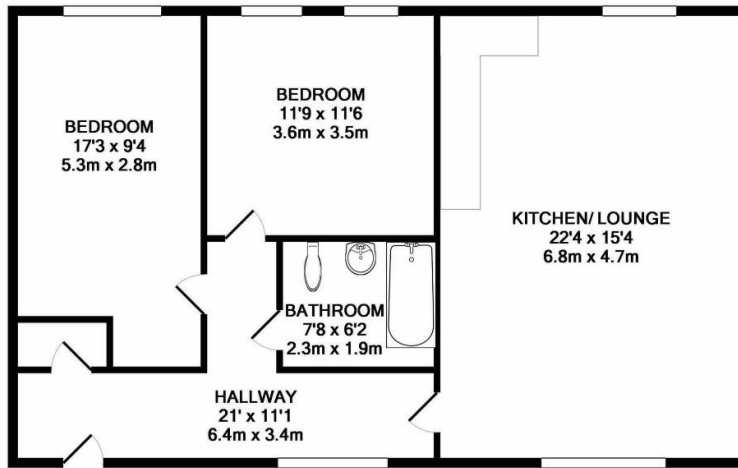

TOTAL APPROX. FLOOR AREA 830 SQ.FT. (77.1 SQ.M.)

Whilst every attempt has been made to ensure the accuracy of the floor plan contained here, measurements of doors, windows, rooms and any other items are approximate and no responsibility is taken for any error, omission, or mis-statement. This plan is for illustrative purposes only and should be used as such by any prospective purchaser. The services, systems and appliances shown have not been tested and no guarantee as to their operability or efficiency can be given  
 Made with Metropix ©2019

**VIEWING BY APPOINTMENT WITH AGENTS**

Abacus Estates

OPEN MON-FRI 8.00AM TO 7.00PM

SAT - 9.30AM TO 4.00PM

SUN - BY PRIOR APPOINTMENT

**Important Notice**

1. These particulars have been prepared in all good faith to give a fair overall view of the property. If any points are particularly relevant to your interest in the property please ask for further information/ verification.
2. The photograph depicts only certain parts of the property. The fittings illustrated may be included with the apartment/ house although the joinery and paint finishes may differ. No assumptions should be made with regards to parts of the property. Please ask for further information if required.
3. Any areas, measurements or distances referred to are given as a guide only and are not precise. If such details are fundamental to a purchase, purchasers must rely on their own enquires.
4. Descriptions of the property are subjective and are used in good faith as an opinion and a statement of fact. Please make further specific enquires to ensure that our descriptions are likely to match any expectations you may have of the property.

N.B. Abacus Estates is a Trading name for and on behalf of Lenscane Limited.