

# A-B-A-C-U-S

KENSAL RISE

## Riffel Road, Willesden Green London, NW2

A sizeable 2 bedroom apartment of 786 SQFT set on the first floor of this period conversion. Offered in generally good condition throughout and located within easy reach to Willesden Green (Jubilee Line) station and all local cafes and shops of the popular Walm Lane.



**£465,000 Leasehold**

103 CHAMBERLAYNE ROAD • KENSAL RISE • LONDON NW10 3NS

T: 020 3815 5777 • E: HEADOFFICE@ABACUSESTATES.COM • W: ABACUSESTATES.COM

ABACUS ESTATES IS A TRADING NAME FOR AND ON BEHALF OF ABACUS ESTATES (LONDON) LIMITED NO: 099182841 - VAT REGISTRATION NO: 223 0774 34 - REGISTERED OFFICE: 103 CHAMBERLAYNE ROAD, LONDON, NW10 3NS



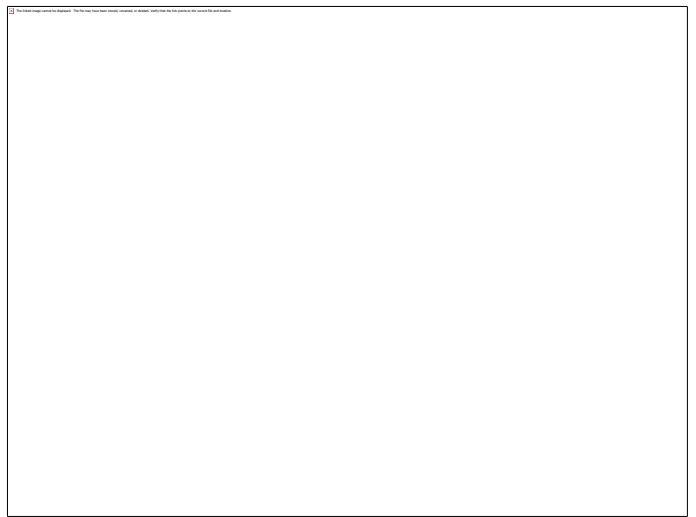

| Energy Efficiency Rating                    |                         |           |
|---|-------------------------|-----------|
|   | Current                 | Potential |
| Very energy efficient - lower running costs |                         |           |
| (92-100) <b>A</b>                           |                         |           |
| (81-91) <b>B</b>                            |                         |           |
| (69-80) <b>C</b>                            |                         |           |
| (55-68) <b>D</b>                            |                         |           |
| (39-54) <b>E</b>                            |                         |           |
| (21-38) <b>F</b>                            |                         |           |
| (1-20) <b>G</b>                             |                         |           |
| Not energy efficient - higher running costs |                         |           |
| <b>England, Scotland &amp; Wales</b>        | EU Directive 2002/91/EC |           |

| Environmental Impact (CO <sub>2</sub> ) Rating                  |                         |           |
|---|-------------------------|-----------|
|   | Current                 | Potential |
| Very environmentally friendly - lower CO <sub>2</sub> emissions |                         |           |
| (92-100) <b>A</b>   |                         |           |
| (81-91) <b>B</b>  |                         |           |
| (69-80) <b>C</b>  |                         |           |
| (55-68) <b>D</b>  |                         |           |
| (39-54) <b>E</b>  |                         |           |
| (21-38) <b>F</b>  |                         |           |
| (1-20) <b>G</b>   |                         |           |
| Not environmentally friendly - higher CO <sub>2</sub> emissions |                         |           |
| <b>England, Scotland &amp; Wales</b>                            | EU Directive 2002/91/EC |           |



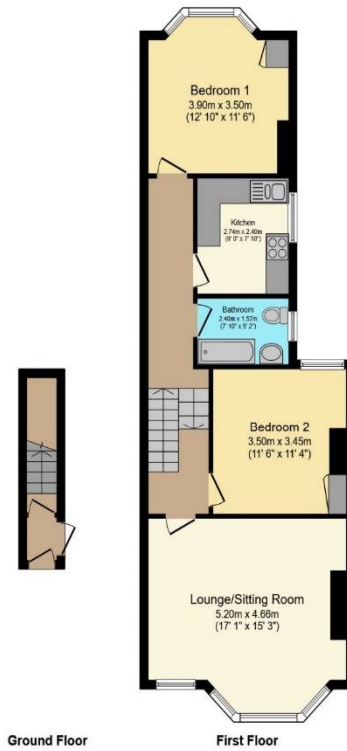

Total floor area 73.0 sq. m. (786 sq. ft.) approx

This floor plan is for illustrative purposes only. It is not drawn to scale. Any measurements, floor areas (including any total floor area), openings and orientation are approximate. No details are guaranteed, they cannot be relied upon for any purpose and they do not form part of any agreement. No liability is taken for any error, omission or misstatement. A party must rely upon its own inspection(s). Plan produced for Purple Bricks. Powered by www.focalagent.com

#### VIEWING BY APPOINTMENT WITH AGENTS

Abacus Estates

OPEN MON-FRI 8.00AM TO 7.00PM

SAT - 9.30AM TO 4.00PM

SUN - BY PRIOR APPOINTMENT

#### Important Notice

1. These particulars have been prepared in all good faith to give a fair overall view of the property. If any points are particularly relevant to your interest in the property please ask for further information/ verification.
2. The photograph depicts only certain parts of the property. The fittings illustrated may be included with the apartment/ house although the joinery and paint finishes may differ. No assumptions should be made with regards to parts of the property. Please ask for further information if required.
3. Any areas, measurements or distances referred to are given as a guide only and are not precise. If such details are fundamental to a purchase, purchasers must rely on their own enquires.
4. Descriptions of the property are subjective and are used in good faith as an opinion and a statement of fact. Please make further specific enquires to ensure that our descriptions are likely to match any expectations you may have of the property.