



**Turnham Green Terrace, Chiswick, W4**

0 Bedrooms

**£1,200 per month**



LONDON ESTATES



Spacious studio | Wooden flooring throughout | Central Heating | Double Glazing | Good transport links | Newly refurbished

Available Date: 28<sup>th</sup> October 2021

EPC Rating: E | Council Tax: D - £1,200 per month



LONDON ESTATES

## Turnham Green Terrace

Approx. Gross Internal Area

39 Sq M - 416 Sq Ft

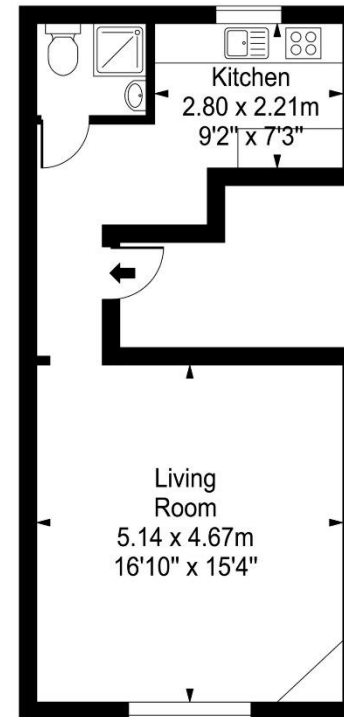

First Floor

Every attempt is made to assure accuracy, however measurements are approximate and for illustrative purposes only. Not to scale.  
Floor plan by [www.frameworkphotos.co.uk](http://www.frameworkphotos.co.uk)