



Minford Gardens, West Kensington, W14

Charcroft Court | 1 Bedrooms

£1,400 per month



LONDON ESTATES



Excellent location | Lots of storage | Double Glazed Windows | Communal Gardens | Separate laundry room | Good Transport Links

Available Date: 16th December 2022

EPC Rating: C | Council Tax: B - £1,400 per month



LONDON ESTATES

Charcroft Court

Approx. Gross Internal Area
50 Sq M - 538 Sq Ft

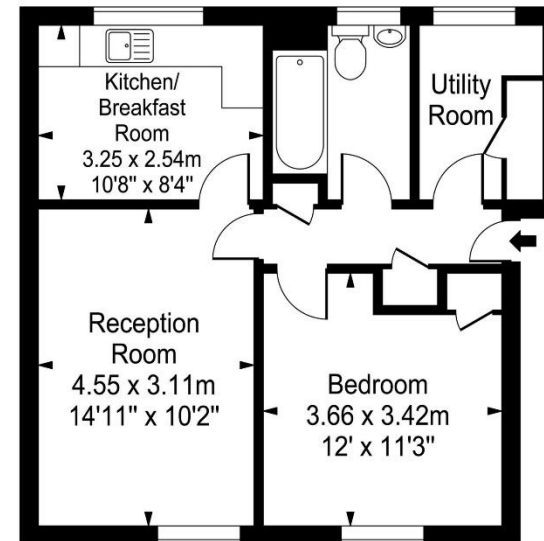

Ground Floor

Every attempt is made to assure accuracy, however measurements are approximate and for illustrative purposes only. Not to scale.
Floor plan by www.frameworkphotos.co.uk