



Chiswick High Road, Chiswick, W4

2 Bedrooms

£1,800 per month



LONDON ESTATES



Two double bedrooms | Eat-in kitchen | Bright and spacious | Excellent location | Good transport links | Great local amenities

Available Date: 8th January 2022

EPC Rating: B | Council Tax: E - £1,800 per month



LONDON ESTATES

Chiswick High Road

Approx. Gross Internal Area
68.69 Sq M - 739 Sq Ft

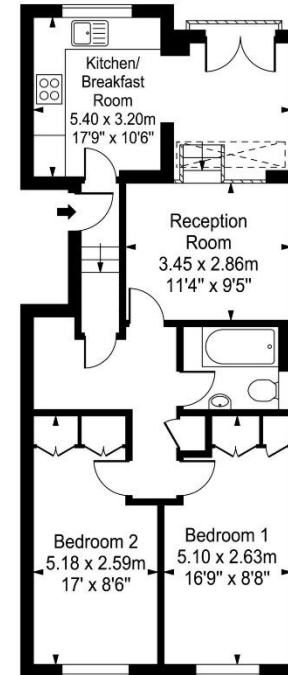

Second Floor

Every attempt is made to assure accuracy, however measurements are approximate and for illustrative purposes only. Not to scale.
Floor plan by www.frameworkphotos.co.uk