



Dalling Road, Hammersmith, W6

3 Bedrooms

£2,350 per month



LONDON ESTATES



NEW KITCHEN | NEWLY DECORATED | EXCELLENT LOCATION | SEPARATE
EAT IN KITCHEN | TWO BATHROOMS | WOODEN FLOORS

Available Date: 1st August 2021

EPC Rating: D | Council Tax: E - £2,350 per month



LONDON ESTATES

Dalling Road

Approx. Gross Internal Area

86 Sq M - 925 Sq Ft

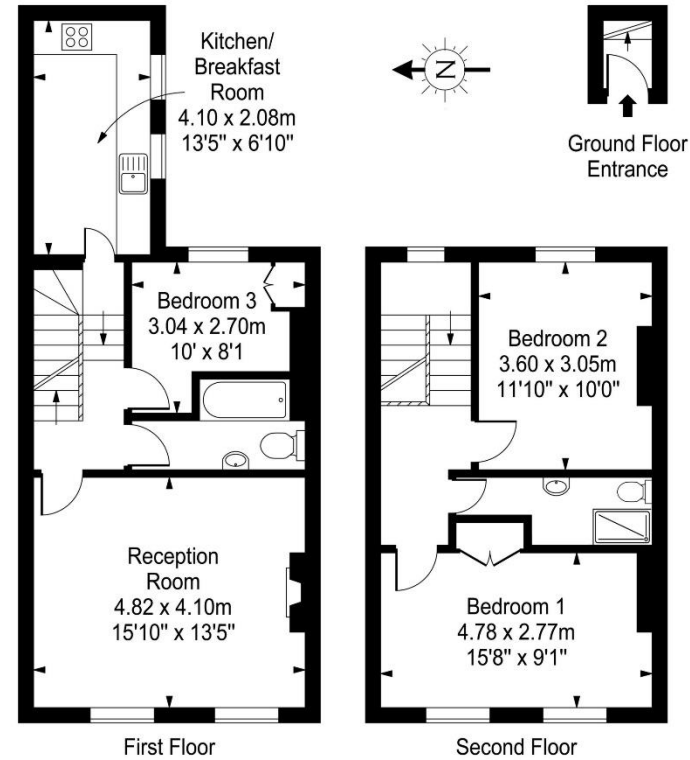

Every attempt is made to assure accuracy, however
measurements are approximate and for illustrative purposes only. Not to scale.
Floor plan by www.frameworkphotos.co.uk