



Cranbrook Road, Chiswick, W4

2 Bedrooms

£2,395 per month



LONDON ESTATES



SPLIT-LEVEL APARTMENT | TWO DOUBLE BEDROOMS | SEPARATE
KITCHEN/DINING SPACE | GREAT TRANSPORT LINKS | AMAZING LOCATION

Available Date: 15th November 2024

EPC Rating: D | Council Tax: D - £2,395 per month



LONDON ESTATES

Cranbrook Road

Approx. Gross Internal Area

71 Sq M - 764 Sq Ft

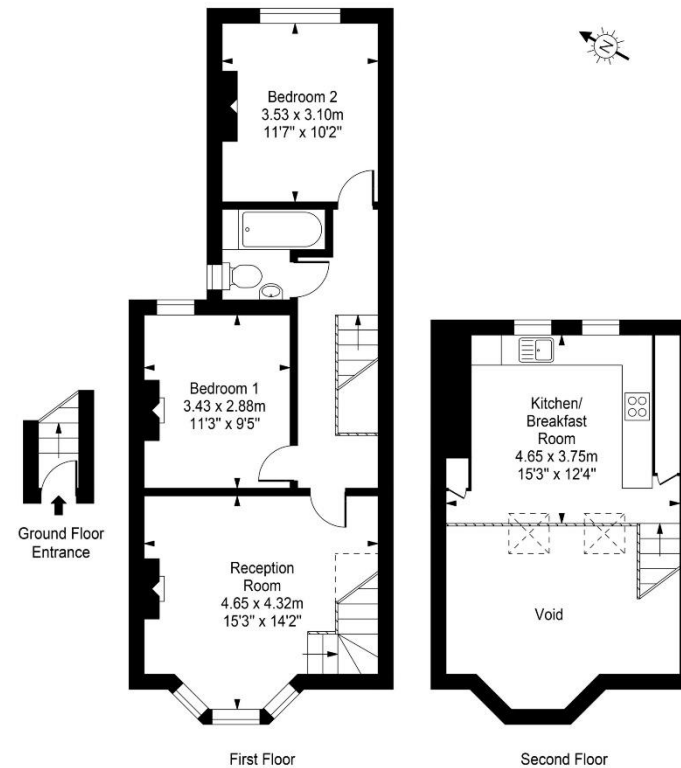

Every attempt is made to assure accuracy, however
measurements are approximate and for illustrative purposes only. Not to scale.
Floor plan by www.frameworkphotos.co.uk