



Windmill Road, Ealing, W5

3 Bedrooms

£1,825 per month



LONDON ESTATES



NEWLY DECORATED | RECEPTION AND DINING ROOM | LARGE PATIO REAR GARDEN | FULL BATHROOM SUITE WITH SHOWER CUBICLE | GREAT

Available Date: 14th August 2021

EPC Rating: C | Council Tax: E - £1,825 per month



LONDON ESTATES

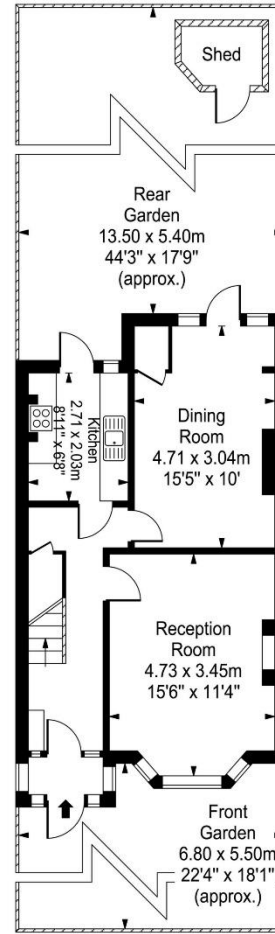

Windmill Road

Approx. Gross Internal Area
91 Sq M - 985 Sq Ft

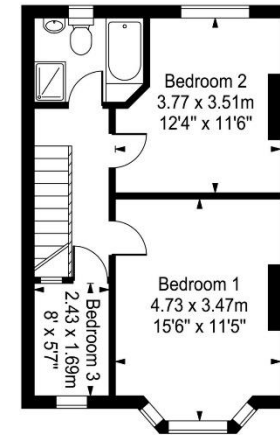

Every attempt is made to assure accuracy, however measurements are approximate and for illustrative purposes only. Not to scale.
Floor plan by www.frameworkphotos.co.uk