

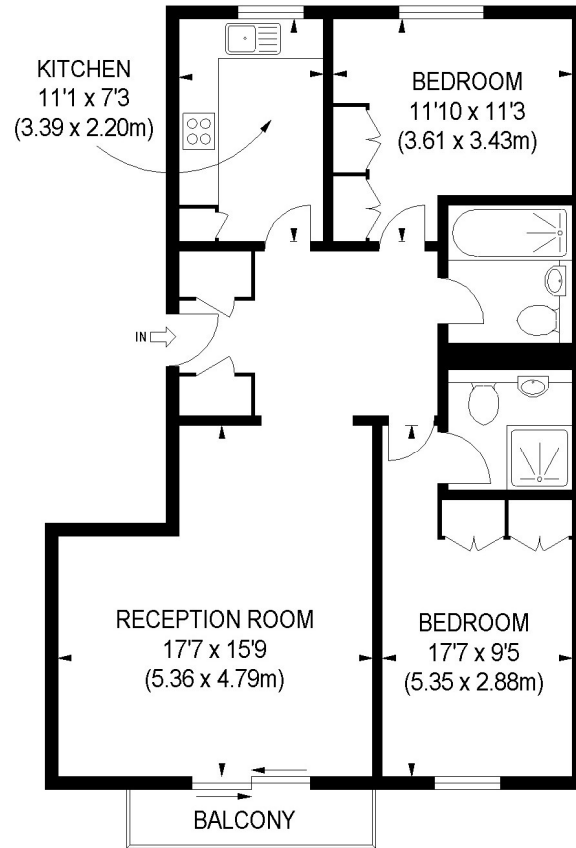

Hartfield Crescent, SW19

Seymour Green are delighted to offer a very well presented flat situated on the 2nd floor (with lift) of this very popular residential building located just moments from Wimbledon Tube and Mainline Stations. Boasting 820 sq feet the property comprises a wonderful living room with balcony offering superb views, a well fitted kitchen with integral appliances, a generous master bedroom with en suite shower room and built in wardrobes, a further good size double bedroom with built in wardrobes and further full bathroom. The property also benefits from a useful allocated underground parking space.

£1,700 per month



FIRST FLOOR

APPROX. GROSS INTERNAL FLOOR AREA 819 SQ FT / 76.09 SQ M

**Illustration for identification purposes only, not to scale
All measurements are maximum, and includes wardrobes and window bays where applicable
Prepared by Pixangle © . Tel 020 8870 2118**

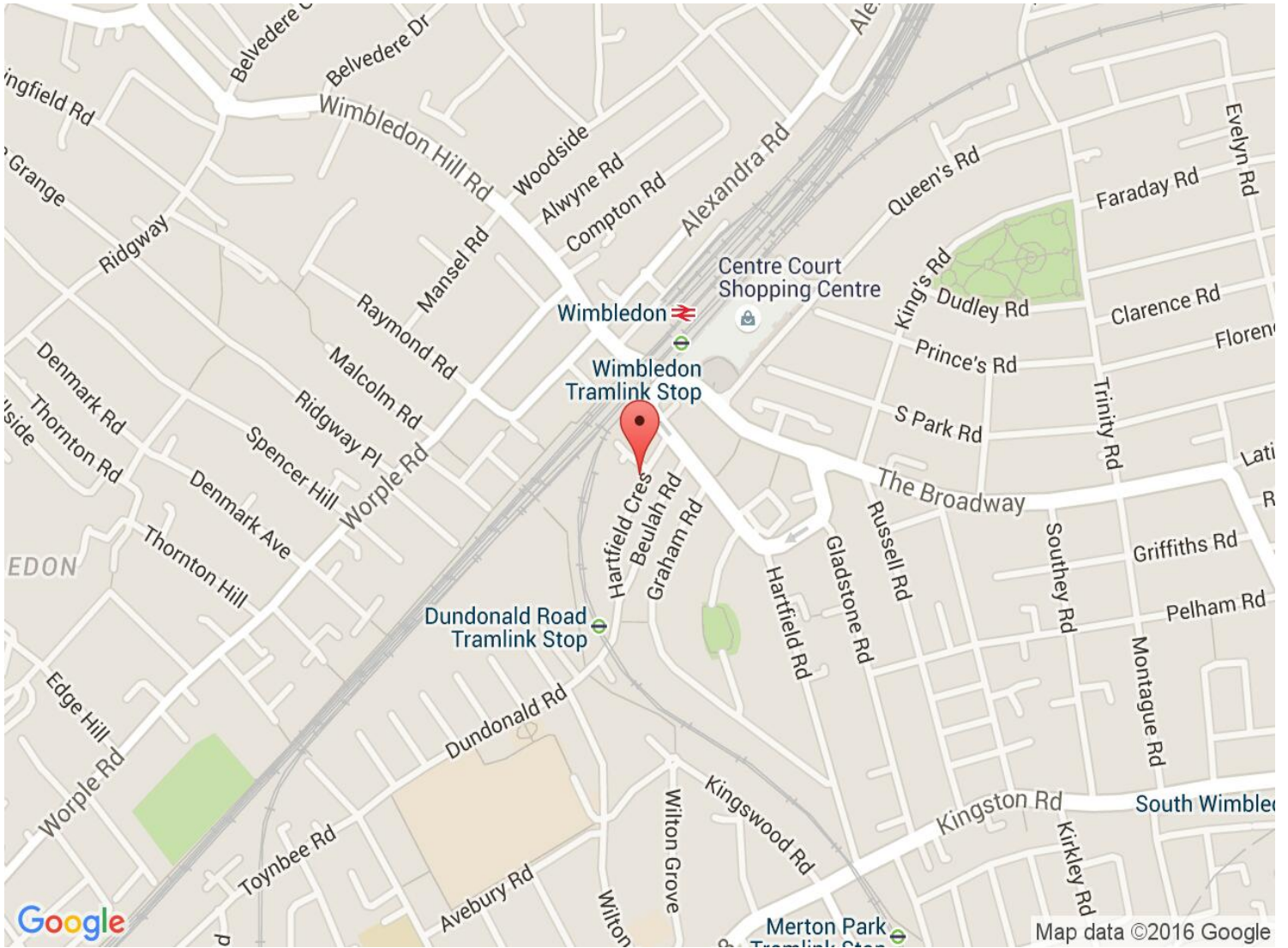

Energy Efficiency Rating		Current	Potential
Very energy efficient - lower running costs			
(92-100) A			
(81-91) B			
(69-80) C		76	81
(55-68) D			
(39-54) E			
(21-38) F			
(1-20) G			
Not energy efficient - higher running costs			
England & Wales	EU Directive 2002/91/EC		

Environmental Impact (CO ₂) Rating		Current	Potential
Very environmentally friendly - lower CO ₂ emissions			
(92-100) A			
(81-91) B			
(69-80) C		79	84
(55-68) D			
(39-54) E			
(21-38) F			
(1-20) G			
Not environmentally friendly - higher CO ₂ emissions			
England & Wales	EU Directive 2002/91/EC		