



**SEYMOURGREEN**  
AT THE HEART ♥ OF YOUR MOVE

## Brookwood Road, Southfields, London, SW18

- ♥ One Double Bedroom
- ♥ Great for Transport
- ♥ Southfields Grid
- ♥ Over Two Floors
- ♥ 895 Sq. Feet
- ♥ Good Decorative Order

A very spacious split level flat located on the popular Southfields Grid, just a short walk to Southfields Tube Station and Southfields Village. The property is comprised of one double bedroom and an additional room which can be used as an office or could double up as a single bedroom, fitted kitchen and modern bathroom.

# To Let: £1,250 per month



Seymour Green, 483 Merton Road, London SW18 5LE

T: 020 8870 0111 F: 020 3302 9598 E: [southfields@seymour-green.co.uk](mailto:southfields@seymour-green.co.uk) W: [seymour-green.co.uk](http://seymour-green.co.uk)



**SEYMOURGREEN**  
AT THE HEART ♥ OF YOUR MOVE

## BROOKWOOD ROAD, SW18

Approx. Gross Internal Floor Area

**895 Sq. ft/83.14 Sq. m**

(Including eaves. Eaves 105 Sq. ft/9.75 Sq. m)

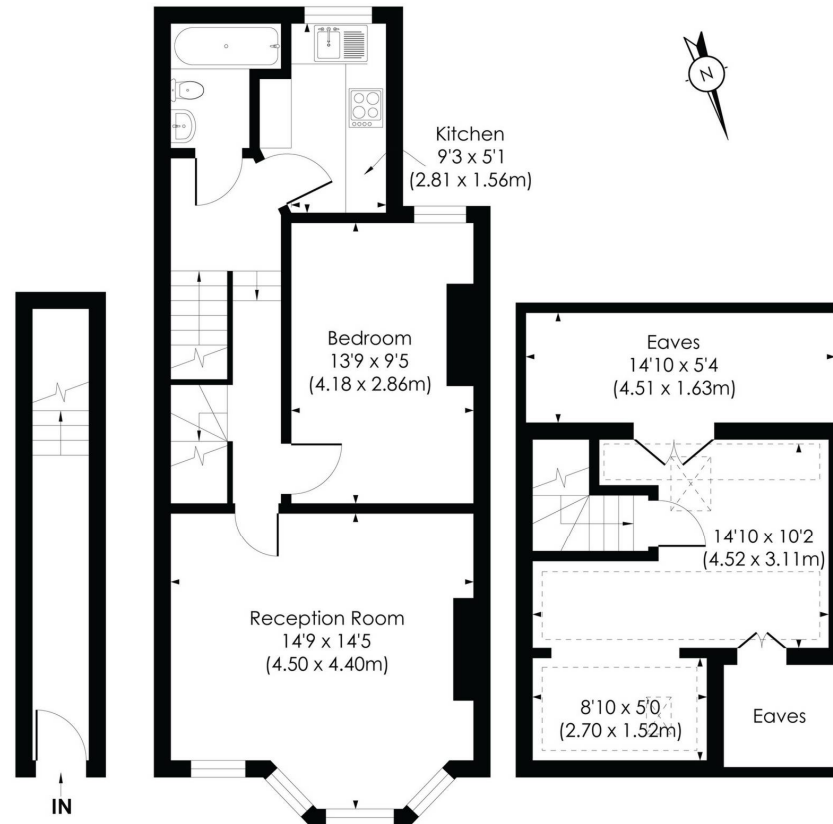

GROUND FLOOR

FIRST FLOOR

SECOND FLOOR

**pixangle**  
PROPERTY MARKETING

This floor plan has been prepared for the purpose of illustration only in accordance with the latest RICS code of measuring practice and is not to scale. All measurements and areas are approximate and whilst every effort has been made to ensure the accuracy of the plan contained here, no responsibility is taken for any error, omission or misstatement.

© Pixangle Property Marketing Ltd. info@pixangle.com Tel: 0208 870 2118



**SEYMOURGREEN**  
AT THE HEART ♥ OF YOUR MOVE

# Brookwood Road, Southfields, London, SW18

## To Let: £1,250 per month



Seymour Green, 483 Merton Road, London SW18 5LE  
T: 020 8870 0111 F: 020 3302 9598 E: [southfields@seymour-green.co.uk](mailto:southfields@seymour-green.co.uk) W: [seymour-green.co.uk](http://seymour-green.co.uk)



SEYMOURGREEN  
AT THE HEART OF YOUR MOVE

# Brookwood Road, Southfields, London, SW18

## To Let: £1,250 per month

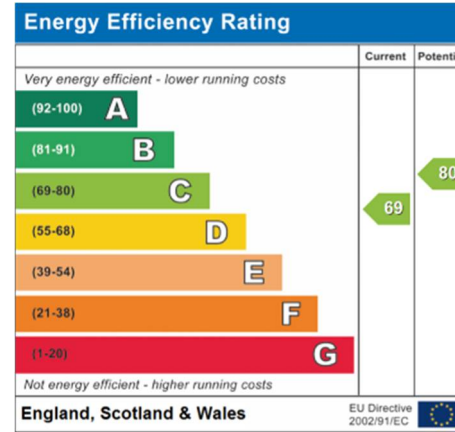

**IMPORTANT NOTICE**  
Descriptions of the property are subjective and are used in good faith as an opinion and NOT as a statement of fact. Please make further specific enquires to ensure that our descriptions are likely to match any expectations you may have of the property. We have not tested any services, systems or appliances at this property. We strongly recommend that all the information we provide be verified by you on inspection, and by your Surveyor and Conveyancer.

Seymour Green, 483 Merton Road, London SW18 5LE  
T: 020 8870 0111 F: 020 3302 9598 E: southfields@seymour-green.co.uk W: seymour-green.co.uk