

CASTLEVIEW HOMES

£1,250 per month

Ashurst Drive, Goring-By-Sea, BN12



- Ground floor aptmnt with garden
- Two double bedrooms
- Off street parking
- Double glazed conservatory
- Pet friendly
- Gas central heating
- Fully double glazed throughout
- Well located on the private Goring Hall estate
- Available from 1st May'21 on a long term let basis

Spacious two double bed roomed ground floor apartment forming part of a purpose built block of only two apartments very well located on the Goring Hall private estate. A few minutes walk from the sea and greensward at Goring seafront. Lovely private and secluded garden to the rear with side access. Ample unrestricted parking on the road as well as off street parking. References and a deposit will be required. This is a PET FRIENDLY rental property.

Ashurst Drive, Goring-By-Sea, BN12

Front

Front of block with this apartment taking up the entire ground floor of this detached block of only two purpose built apartments.

Rear

Rear of block showing the double glazed conservatory and private garden of this apartment.

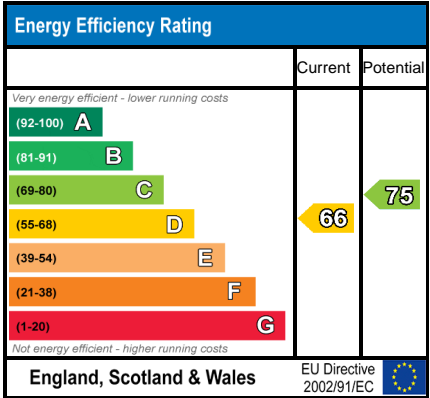
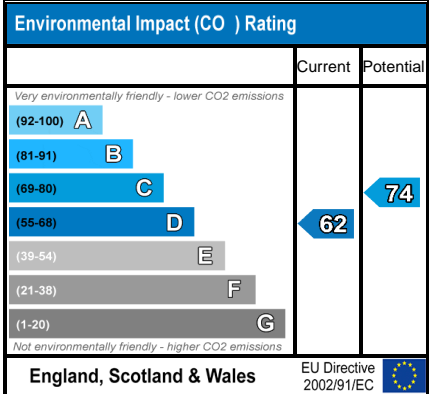

2 BEDROOM GROUND FLOOR APARTMENT

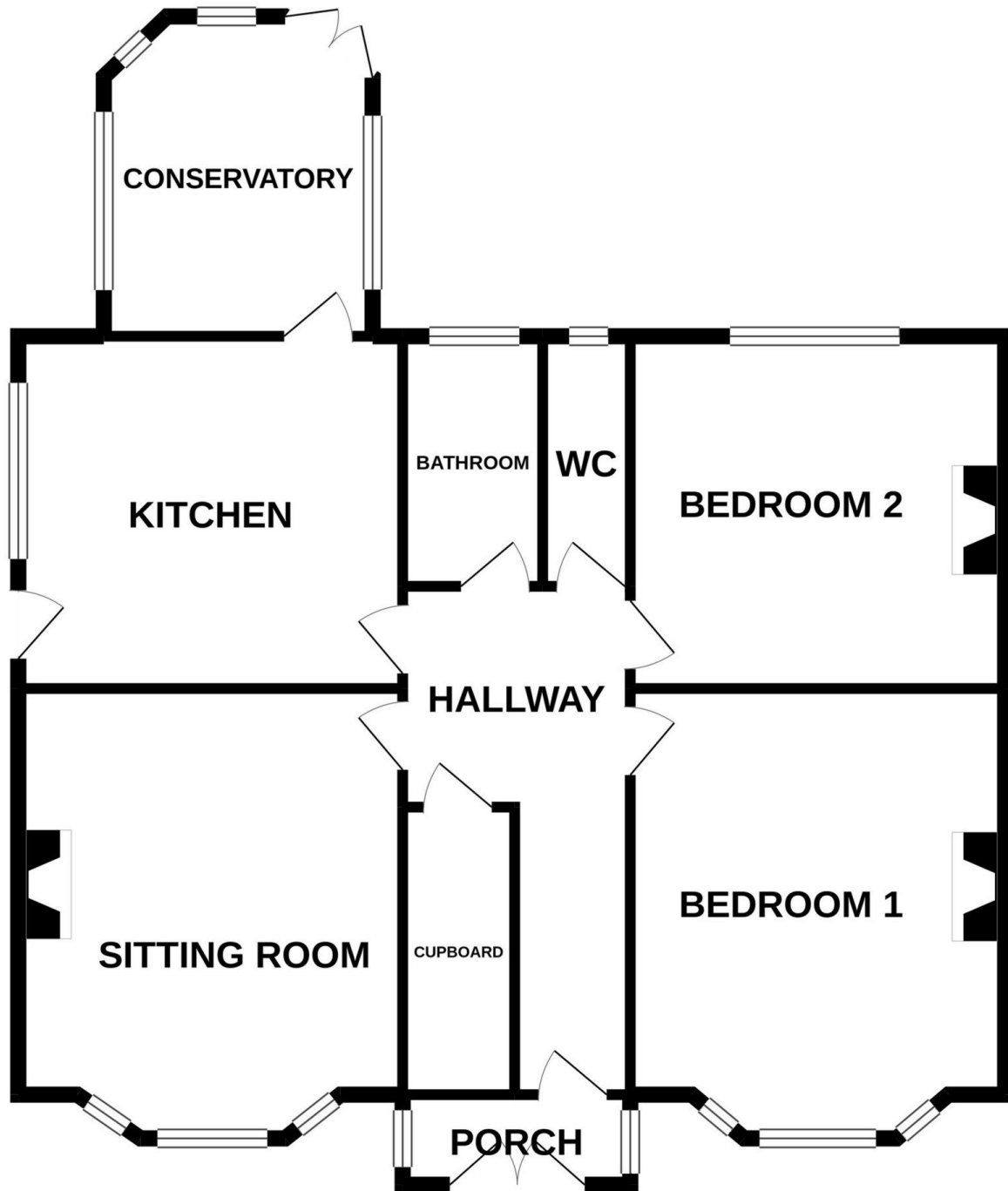

Whilst every attempt has been made to ensure the accuracy of the floorplan contained here, measurements of doors, windows, rooms and any other items are approximate and no responsibility is taken for any error, omission or mis-statement. This plan is for illustrative purposes only and should be used as such by any prospective purchaser. The services, systems and appliances shown have not been tested and no guarantee as to their operability or efficiency can be given.
Made with Metropix ©2020

VIEWING BY APPOINTMENT WITH AGENTS CASTLEVIEW HOMES

292 Goring Road, Goring by Sea, Worthing, West Sussex, BN12 4PE T: 01903 539 539 E: info@castleviewhomes.co.uk W: www.castleviewhomes.co.uk

General: While we endeavour to make our sales particulars fair, accurate and reliable, they are only a general guide to the property and, accordingly, if there is any point which is of particular importance to you, please contact the office and we will be pleased to check the position for you, especially if you are contemplating travelling some distance to view the property.

Measurements: These approximate room sizes are only intended as general guidance. You must verify the dimensions carefully before ordering carpets or any built-in furniture.

Services: Please note we have not tested the services or any of the equipment or appliances in this property, accordingly we strongly advise prospective buyers to commission their own survey or service reports before finalizing their offer to purchase.

THESE PARTICULARS ARE ISSUED IN GOOD FAITH BUT DO NOT CONSTITUTE REPRESENTATIONS OF FACT OR FORM PART OF ANY OFFER OR CONTRACT. THE MATTERS REFERRED TO IN THESE PARTICULARS SHOULD BE INDEPENDENTLY VERIFIED BY PROSPECTIVE BUYERS OR TENANTS. NEITHER CASTLEVIEW HOMES NOR ANY OF ITS EMPLOYEES OR AGENTS HAS ANY AUTHORITY TO MAKE OR GIVE ANY REPRESENTATION OR WARRANTY WHATEVER IN RELATION TO THIS PROPERTY.

YOUR HOME IS AT RISK IF YOU DO NOT KEEP UP REPAYMENTS ON A MORTGAGE OR OTHER LOAN SECURED ON IT.

Written quotations available on request. All loans secured on property. Life assurance is usually required.