



Jenkinson realestates

College Road

Deal

Asking Price £349,950



# Freehold

Energy Performance Rating = D

Detached Bungalow  
Enclosed Rear Garden

Offering Two Double Bedrooms  
Spacious Kitchen / Breakfast Room

Gated Off Road Parking  
Close to Town and Seafront

Jenkinson Estates are pleased to bring to the market this unusual, detached 1920's bungalow situated in the ever popular location of College Road, Deal. Located just two roads back from Deal seafront and promenade, this would certainly make a good family home or ideal purchase for someone looking to escape to the coast. The property is accessed via a spacious entrance hall that leads to the family bathroom and a spacious bay-fronted living room. There is an inner hallway which continues to two double bedrooms and a kitchen / breakfast room. This impressive space at the rear of the property opens to a conservatory, and the enclosed garden. The property also benefits from gated off road parking and has gated side access to the good sized private rear gardens. All viewings are strictly through the appointed Sole Agents Jenkinson Estates.



Council Tax Band C







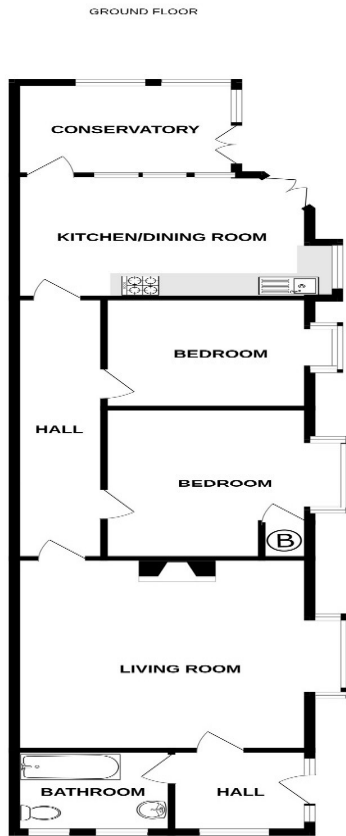

Whilst every attempt has been made to ensure the accuracy of the floorplan contained here, measurements of doors, windows, rooms and any other items are approximate and no responsibility is taken for any error, omission or mis-statement. This plan is for illustrative purposes only and should be used as such by any prospective purchaser. The services, systems and appliances shown have not been tested and no guarantee as to their operability or efficiency can be given.  
Made with Metropix 5/2024

**Jenkinson Estates**  
4 West Street, Deal, Kent, CT14 6AE

01304 373 984  
info@jenkinsonestates.co.uk  
www.jenkinsonestates.co.uk

Important Notice - These particulars have been prepared in good faith and they are not intended to constitute part of an offer or contract. We have not performed a structural survey on this property and the services, appliances and specific fittings have not been tested. All photographs, measurements, floor plans and distances referred to are given as a guide and should not be relied upon.

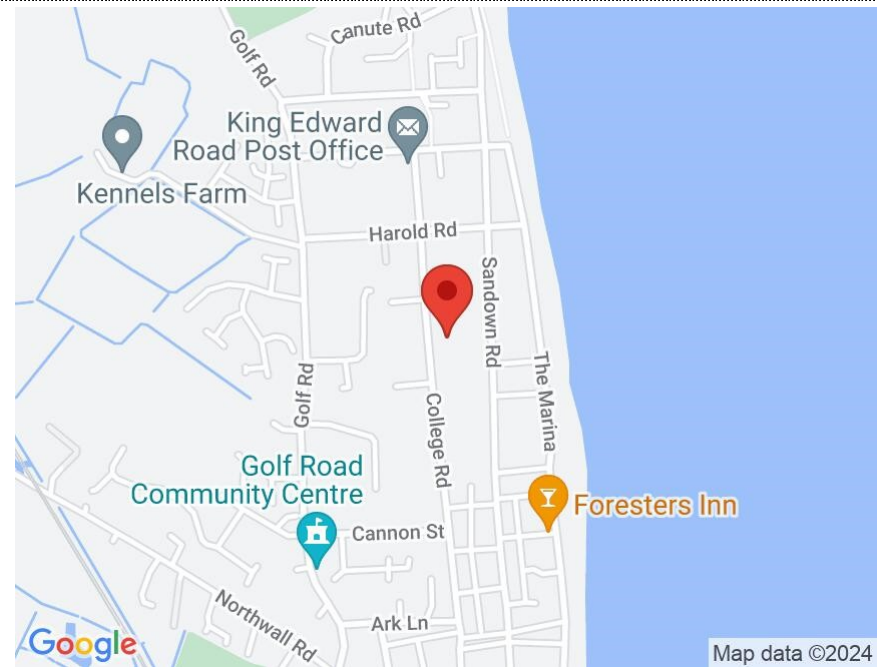

**Accommodation**

**Entrance Hall**

6'9" x 7'1" (2.06m x 2.16m)

**Bathroom**

8'1" x 6'0" (2.46m x 1.83m)

**Living Room**

16'0" x 15'7" (4.88m x 4.75m)

**Inner Hall**

**Bedroom**

11'7" x 10'6" (3.53m x 3.20m)

**Bedroom**

11'6" x 8'8" (3.51m x 2.64m)

**Kitchen / Breakfast Room**

15'3" x 12'1" (4.65m x 3.68m)

**Conservatory**

11'8" x 7'7" (3.56m x 2.31m)

**Rear Garden**

**Side Access**

**Driveway**

