



Greyhound Road, Hammersmith, W6

1 Bedrooms

£1,475 per month



LONDON ESTATES



Open Plan Kitchen/Reception | One Double Bedroom | Shared
Courtyard | Excellent Amenities

Available Date: 19th February 2024

EPC Rating: TBC | Council Tax: B - £1,475 per month



LONDON ESTATES

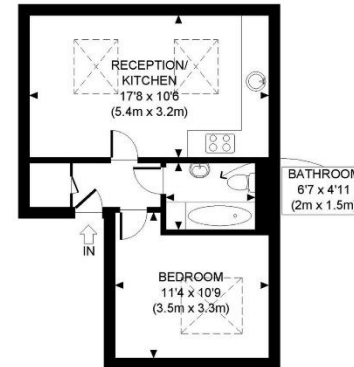

THIRD FLOOR
GROSS INTERNAL
FLOOR AREA 377 SQ FT



APPROX. GROSS INTERNAL FLOOR AREA: 377 SQ FT/ 35 SQM

PROPERTY PHOTO PLANS.co.uk
ONE STOP SHOP FOR PROPERTY MARKETING

This plan is for illustrative purposes only and should be used as such by any prospective client. Whilst every attempt has been made to ensure the accuracy of the Floor Plan contained here, measurements of the doors, windows, rooms and any other items are approximate and no responsibility is taken for any errors, omissions, or misstatement. The services, systems and appliances shown have not been tested and no guarantee as to the operability or efficiency can be given.