



Fulham Palace Road, Hammersmith, W6

5 Bedrooms

£4,650 per month



LONDON ESTATES



AMAZING LOCATION | FIVE BEDROOMS | TWO BATHROOMS | EXCELLENT
TRANSPORT LINKS | CLOSE TO CHARING CROSS HOSPITAL

Available Date: 25th August 2026

EPC Rating: D | Council Tax: E - £4,650 per month



LONDON ESTATES

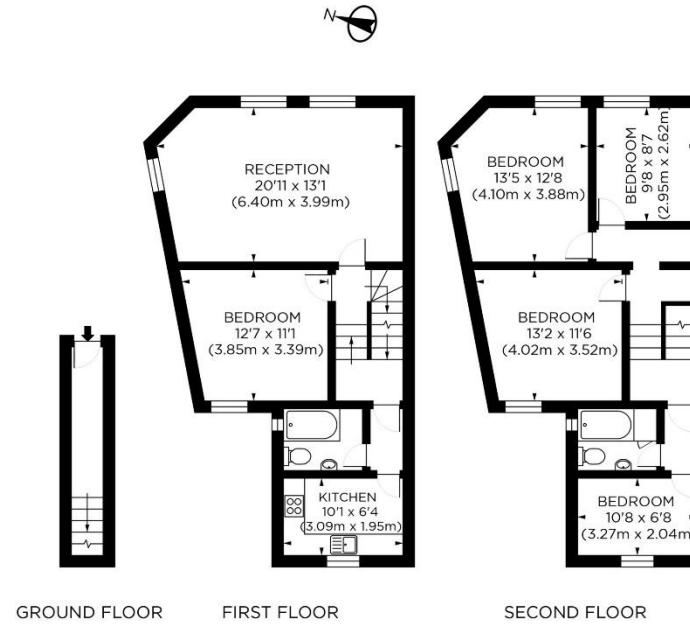

Fulham Palace Road, SW6
Gross Internal Area 1259 sq ft/117 sq metres
c.photosandfloorplans.com