



2 Bedroom 2 Bath Flat
Ravenshaw Street
London NW6

- Two double bedrooms
- Two Bathrooms (Both Ensuite)
- Two reception rooms
- Wood floors

Price: £625 pw / £2,708.33 pcm

Ravenshaw Street, NW6 1NP

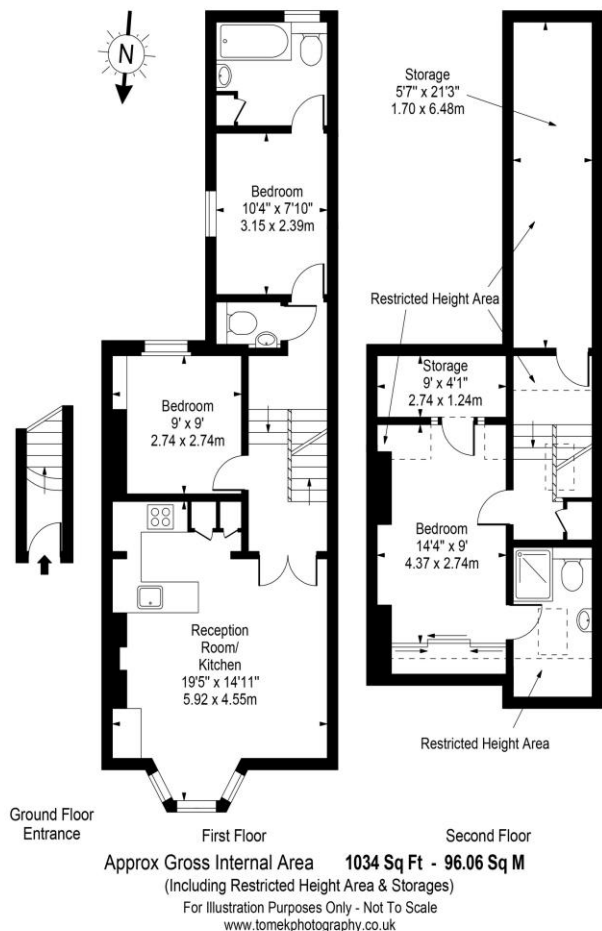

Energy Efficiency Rating		
	Current	Potential
<i>Very energy efficient - lower running costs</i>		
(92-100) A		
(81-91) B		
(69-80) C		73
(55-68) D	53	
(39-54) E		
(21-38) F		
(1-20) G		
<i>Not energy efficient - higher running costs</i>		
England, Scotland & Wales	EU Directive 2002/91/EC	

Wonderfully bright two bedroom two bathroom first and top floor duplex apartment (1034 sq. ft.) within this Victorian conversion located in a tree lined road off Mill Lane and close to the Thameslink. Comprising fitted kitchen/dining room with high gloss integrated appliances and Corian worktops and a dishwasher. Open plan reception room with lots of natural light, hardwood flooring, high ceilings, further reception / guest bedroom, guest wc, double bedroom with ensuite bathroom, top floor master bedroom with fitted wardrobes and ensuite shower room. Part furnished. Ravenshaw Street is within easy reach of the Jubilee line and Brondesbury Overground station as well as a broad choice of independent restaurants and shops.

ML Estates wish to advise prospective purchasers that we have not checked the services or appliances. These particulars have been prepared as a guide only, any floor-plan or map is for illustrative purposes only. ML Estates, for themselves and for the vendors or lessors of this property whose agents they are given notice that: the particulars have been produced in good faith; do not constitute any part of a contract; no person in the employment of ML Estates has any authority to make or give any representation of warranty in relation to this property.