



2 Bedroom Flat
Belsize Road
London NW6

- Raised ground floor
- Two double bedrooms
- South facing reception room
- High ceilings

Asking price of £550,000
Leasehold

Belsize Road, NW6 4AD

Approximate gross Internal Area

51 sq m / 546 sq ft

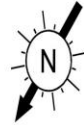

Key :
CH - Ceiling Height

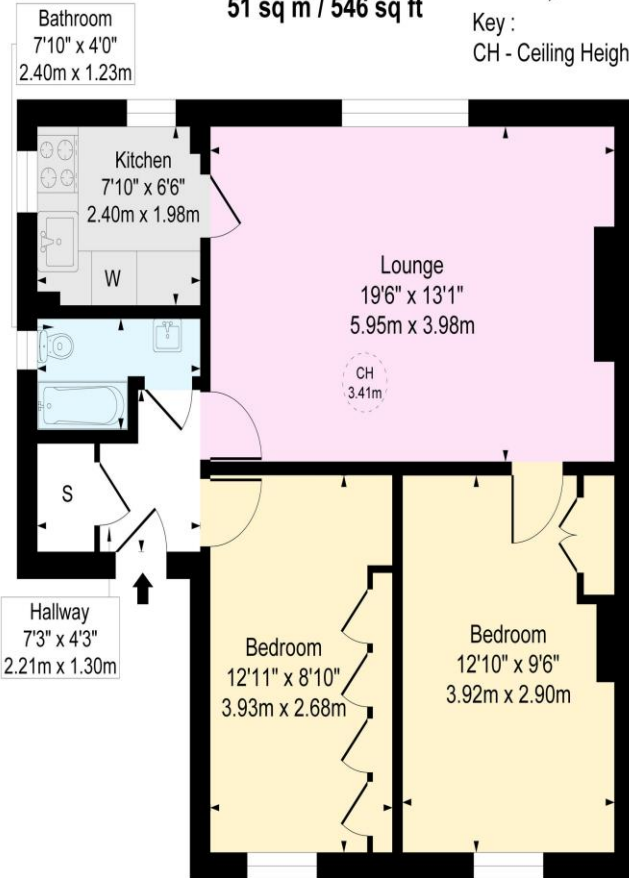

Raised Ground Floor

This floor plan is for illustrative purposes only and must not be relied upon as a statement of fact.



A GRAND TWO DOUBLE-BEDROOM raised ground floor apartment set within this stunning four-storey semi-detached period house. This elegant home features a large reception room with floor to ceiling sash window overlooking the garden, a separate kitchen with dual aspect along with period features. Located within a short walk of South Hampstead Overground and Finchley Road Underground stations.

Energy Efficiency Rating		Current	Potential
<i>Very energy efficient - lower running costs</i>			
(92-100) A			
(81-91) B			
(69-80) C			
(55-68) D		66	79
(39-54) E			
(21-38) F			
(1-20) G			
<i>Not energy efficient - higher running costs</i>			
England, Scotland & Wales		EU Directive 2002/91/EC	

ML Estates wish to advise prospective purchasers that we have not checked the services or appliances. These particulars have been prepared as a guide only, any floor-plan or map is for illustrative purposes only. ML Estates, for themselves and for the vendors or lessors of this property whose agents they are given notice that: the particulars have been produced in good faith; do not constitute any part of a contract; no person in the employment of ML Estates has any authority to make or give any representation of warranty in relation to this property.