



Osbornes
Independent estate agents

Double Bridge Farm
Church Lane | Dogmersfield

Introducing -THE BARN. This charming studio maisonette is now available for immediate occupancy.

Maisonette | Modern Kitchen | Modern Four Piece Bathroom | Off Street Parking x 2 | Use of Tennis Court | Available Now

£1,100 per month

Introducing -THE BARN. This charming studio maisonette is now available for immediate occupancy. The property features a generously sized 10'11" x 10'1" entrance/reception area, a contemporary four-piece bathroom, a large 30'3" living room with an integrated kitchen/bedroom setup, a modern kitchen, off-street parking for two cars, and use of a tennis court. Rent includes most bills, excluding electricity and broadband. Ready for move-in today. Deposit amount: £1,269.24





Approximate Gross Internal Area
Ground Floor = 17 sq m / 183 sq ft
First Floor = 40.3 sq m / 434 sq ft
Total = 57.3 sq m / 617 sq ft



First Floor

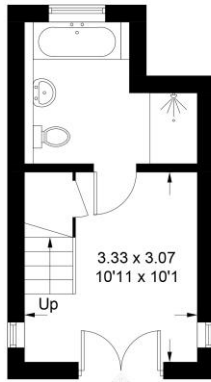

Ground Floor



The Barn

Illustration for identification purposes only, measurements are approximate, not to scale. FloorplansUsketch.com © 2024 (ID1074102)

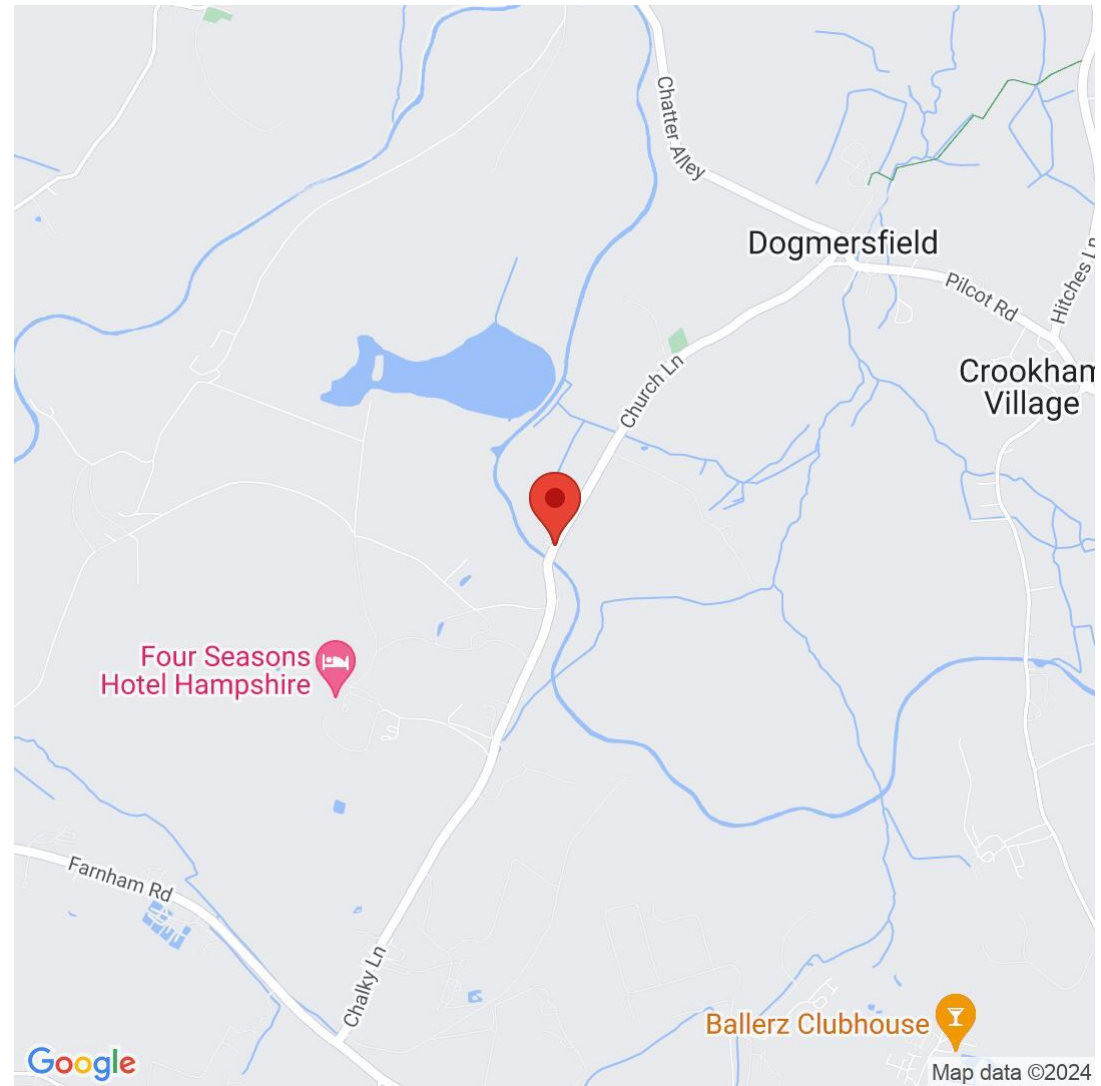

Osbornes Estate Agents

38a Camp Road, Farnborough, Hampshire, GU14

01252 370707 | info@osbornesestateagents.co.uk | www.osbornesestateagents.co.uk

Important Notice - These particulars have been prepared in good faith and they are not intended to constitute part of an offer or contract. We have not performed a structural survey on this property and the services, appliances and specific fittings have not been tested. All photographs, measurements, floor plans and distances referred to are given as a guide and should not be relied upon.