



SEYMOURGREEN
AT THE HEART ♥ OF YOUR MOVE

Durnsford Road, Wimbledon, London, SW19

- ♥ Available Immediately
- ♥ Private Balcony
- ♥ Secure Parking
- ♥ Open Plan Living Space
- ♥ Modern and Stylish
- ♥ Generous Double Bedroom

A stylish first floor flat set within this modern development conveniently located with good transport links close by along with an allocated underground parking space. The property comes unfurnished and comprises, open plan living room and kitchen with door to private balcony, good size double bedroom with built in wardrobe and modern bathroom.

To Let: £1,650 per month



Seymour Green, 483 Merton Road, London SW18 5LE

T: 020 8870 0111 F: 020 3302 9598 E: southfields@seymour-green.co.uk W: seymour-green.co.uk



SEYMOURGREEN
AT THE HEART ♥ OF YOUR MOVE

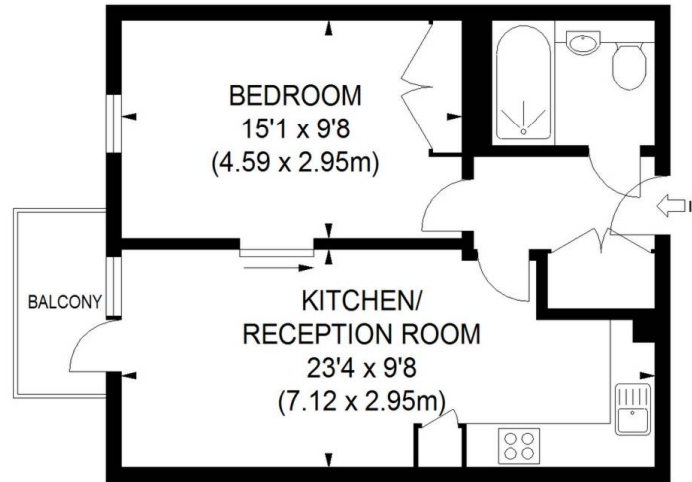

FIRST FLOOR

APPROX. GROSS INTERNAL FLOOR AREA 469 SQ FT / 43.57 SQ M

**Illustration for identification purposes only, not to scale
All measurements are maximum, and includes wardrobes and window bays where applicable
Prepared by Pixangle © . Tel 020 8870 2118**



SEYMOURGREEN
AT THE HEART ♥ OF YOUR MOVE

Durnsford Road, Wimbledon, London, SW19

To Let: £1,650 per month



Seymour Green, 483 Merton Road, London SW18 5LE
T: 020 8870 0111 F: 020 3302 9598 E: southfields@seymour-green.co.uk W: seymour-green.co.uk



SEYMOURGREEN
AT THE HEART ♥ OF YOUR MOVE

Durnsford Road, Wimbledon, London, SW19

To Let: £1,650 per month

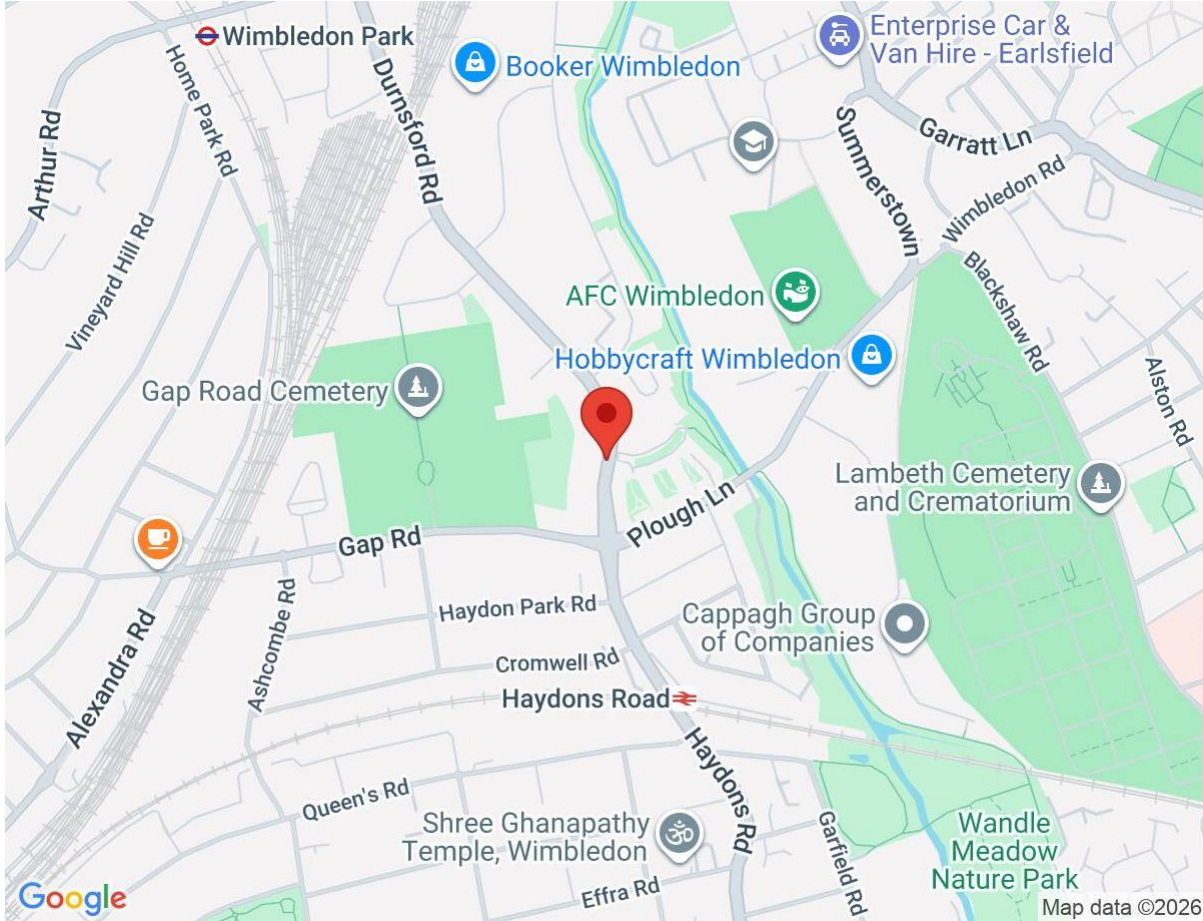

Energy Efficiency Rating		
	Current	Potential
Very energy efficient - lower running costs		
(92-100) A		
(81-91) B	85	86
(69-80) C		
(55-68) D		
(39-54) E		
(21-38) F		
(1-20) G		
Not energy efficient - higher running costs		
EU Directive 2002/91/EC		
England, Scotland & Wales		



IMPORTANT NOTICE
Descriptions of the property are subjective and are used in good faith as an opinion and NOT as a statement of fact. Please make further specific enquires to ensure that our descriptions are likely to match any expectations you may have of the property. We have not tested any services, systems or appliances at this property. We strongly recommend that all the information we provide be verified by you on inspection, and by your Surveyor and Conveyancer.

Seymour Green, 483 Merton Road, London SW18 5LE
T: 020 8870 0111 F: 020 3302 9598 E: southfields@seymour-green.co.uk W: seymour-green.co.uk