



SEYMOURGREEN
AT THE HEART ♥ OF YOUR MOVE

Strathville Road, Earlsfield, London, SW18

- ♥ Edwardian Masionette
- ♥ Private Rear Garden
- ♥ Share Of Freehold
- ♥ Excellent Location
- ♥ In Need of Updating
- ♥ No Onward Chain

One bedroom ground floor maisonette ideally located on this highly desirable residential road in Earlsfield just 7-8 minutes walk to Earlsfield Station along with the shops, bars and restaurants of Garratt Lane. The property is in need of updating and is offered for sale with SHARE OF FREEHOLD and no onward chain.

For Sale: £500,000



Seymour Green, 483 Merton Road, London SW18 5LE

T: 020 8870 0111 F: 020 3302 9598 E: southfields@seymour-green.co.uk W: seymour-green.co.uk



SEYMOURGREEN
AT THE HEART ♥ OF YOUR MOVE

STRATHVILLE ROAD, SW18

Approx. Gross Internal Floor Area

504 Sq. ft/46.82 Sq. m

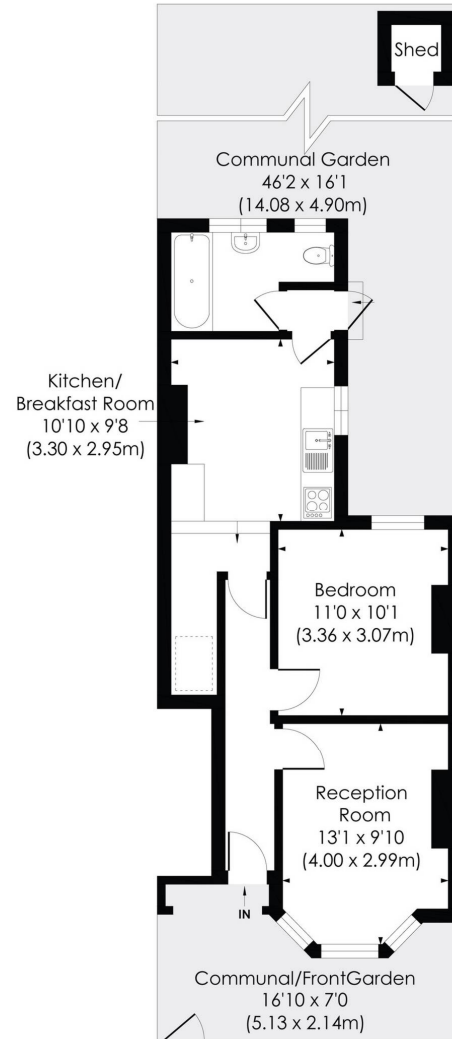

GROUND FLOOR

© Pixangle Property Marketing Ltd. info@pixangle.com Tel: 0208 870 2118

pixangle
PROPERTY MARKETING

This floor plan has been prepared for the purpose of illustration only in accordance with the latest RICS code of measuring practice and is not to scale. All measurements and areas are approximate and whilst every effort has been made to ensure the accuracy of the plan contained here, no responsibility is taken for any error, omission or misstatement.



SEYMOURGREEN
AT THE HEART ♥ OF YOUR MOVE

Strathville Road, Earlsfield, London, SW18

For Sale: £500,000



Seymour Green, 483 Merton Road, London SW18 5LE
T: 020 8870 0111 F: 020 3302 9598 E: southfields@seymour-green.co.uk W: seymour-green.co.uk



SEYMOURGREEN
AT THE HEART ♥ OF YOUR MOVE

Strathville Road, Earlsfield, London, SW18

For Sale: £500,000

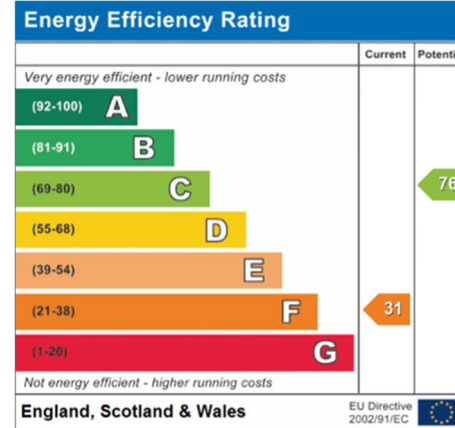
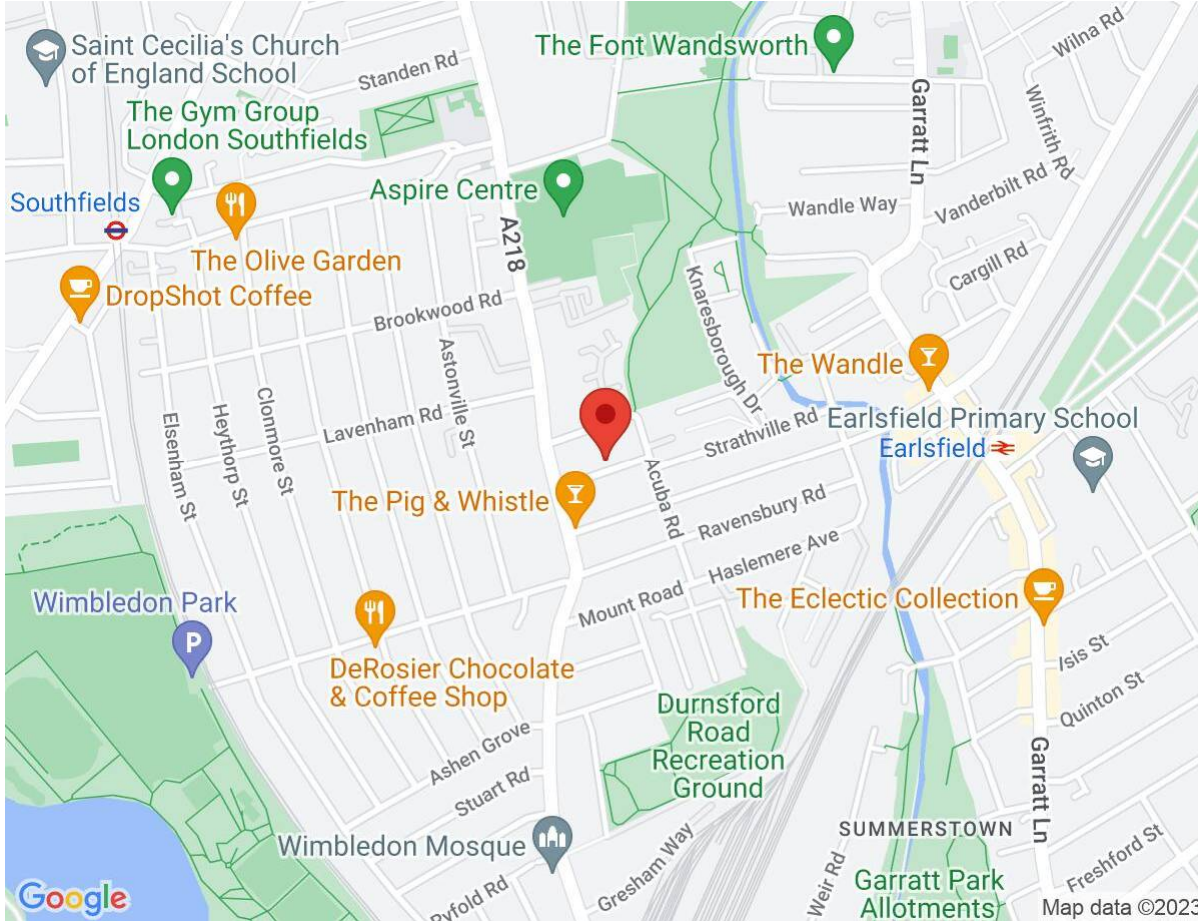

IMPORTANT NOTICE
Descriptions of the property are subjective and are used in good faith as an opinion and NOT as a statement of fact. Please make further specific enquires to ensure that our descriptions are likely to match any expectations you may have of the property. We have not tested any services, systems or appliances at this property. We strongly recommend that all the information we provide be verified by you on inspection, and by your Surveyor and Conveyancer.

Seymour Green, 483 Merton Road, London SW18 5LE
T: 020 8870 0111 F: 020 3302 9598 E: southfields@seymour-green.co.uk W: seymour-green.co.uk