



SEYMOURGREEN
AT THE HEART ♥ OF YOUR MOVE

Longfield Street, Southfields, London, SW18

- ♥ New Build Apartment
- ♥ Large Lock Up Store Room
- ♥ Entryphone System
- ♥ CAT 6 Cabling
- ♥ Wood Floors
- ♥ Private Garden

A fantastic opportunity to be the first tenants of this stunning new build apartment located in the heart of Southfields just a few minutes walk from the tube.

To Let: £1,800 per month

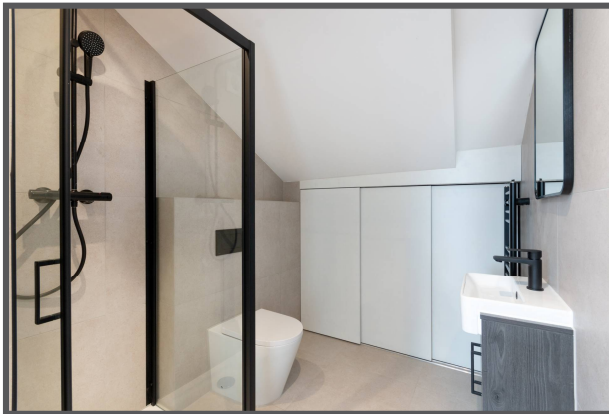

Seymour Green, 483 Merton Road, London SW18 5LE

T: 020 8870 0111 F: 020 3302 9598 E: southfields@seymour-green.co.uk W: seymour-green.co.uk



SEYMOURGREEN
AT THE HEART ♥ OF YOUR MOVE

LONGFIELD STREET, SW18

Approx. Gross Internal Floor Area

601 Sq. ft/55.86 Sq. m (Including reduced height)

536 Sq. ft/49.83 Sq. m (Excluding reduced height)

Storage Room: 26 Sq.ft/2.37 Sq. m

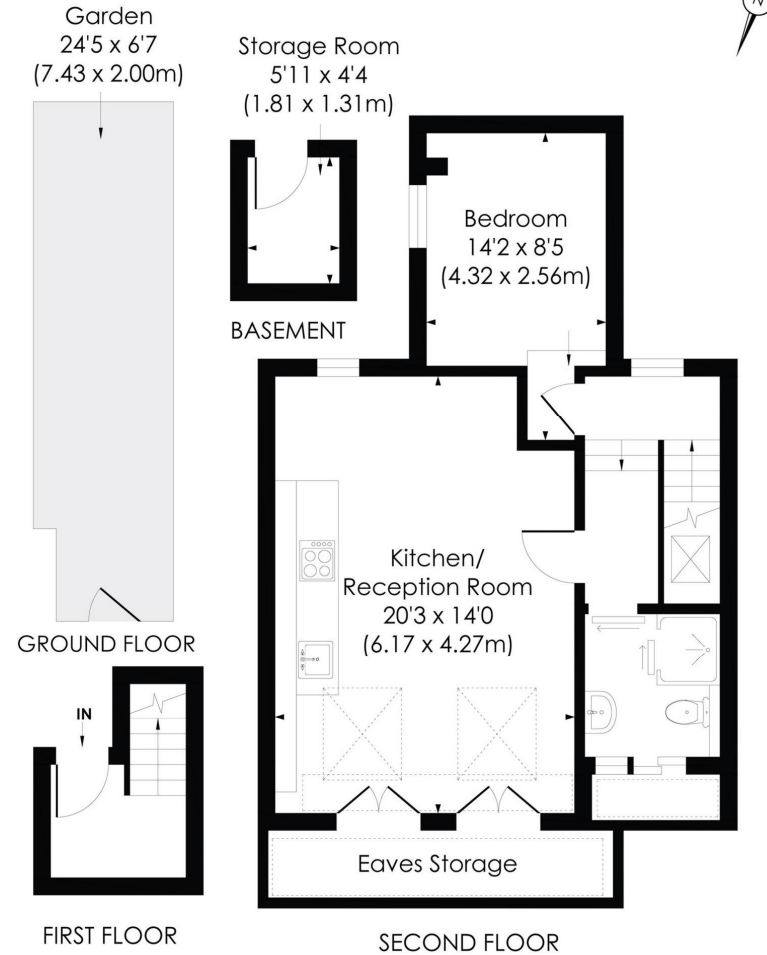

© Pixangle Property Marketing Ltd. info@pixangle.com Tel: 0208 870 2118

pixangle
PROPERTY MARKETING

This floor plan has been prepared for the purpose of illustration only in accordance with the latest RICS code of measuring practice and is not to scale. All measurements and areas are approximate and whilst every effort has been made to ensure the accuracy of the plan contained here, no responsibility is taken for any error, omission or misstatement.

Longfield Street, Southfields, London, SW18

To Let: £1,800 per month





SEYMOURGREEN
AT THE HEART OF YOUR MOVE

Longfield Street, Southfields, London, SW18

To Let: £1,800 per month



Energy Efficiency Rating		
	Current	Potential
Very energy efficient - lower running costs		
(92-100) A	91	91
(81-91) B		
(69-80) C		
(55-68) D		
(39-54) E		
(21-38) F		
(1-20) G		
Not energy efficient - higher running costs		
England, Scotland & Wales		
EU Directive 2002/91/EC		



IMPORTANT NOTICE
Descriptions of the property are subjective and are used in good faith as an opinion and NOT as a statement of fact. Please make further specific enquires to ensure that our descriptions are likely to match any expectations you may have of the property. We have not tested any services, systems or appliances at this property. We strongly recommend that all the information we provide be verified by you on inspection, and by your Surveyor and Conveyancer.

Seymour Green, 483 Merton Road, London SW18 5LE
T: 020 8870 0111 F: 020 3302 9598 E: southfields@seymour-green.co.uk W: seymour-green.co.uk