



SEYMOURGREEN

AT THE HEART ♥ OF YOUR MOVE

Weydown Close, Southfields, London, SW19

- ♥ Two Double Bedrooms
- ♥ Large Living Room
- ♥ Fabulous Bathroom
- ♥ Stunning Condition Throughout
- ♥ Wood Floors
- ♥ Well Fitted Modern Kitchen

A Fabulous first floor flat, well located for both Southfields Village and the wide open spaces of Wimbledon Common offered for sale with No Onward Chain. The flat has recently been decorated throughout and comprises a delightful living room with wood floor and door to the balcony, a well fitted kitchen with appliances included, two spacious double bedrooms, and modern bathroom.

For Sale: £350,000



Seymour Green, 483 Merton Road, London SW18 5LE

T: 020 8870 0111 F: 020 3302 9598 E: southfields@seymour-green.co.uk W: seymour-green.co.uk



SEYMOURGREEN

AT THE HEART ♥ OF YOUR MOVE

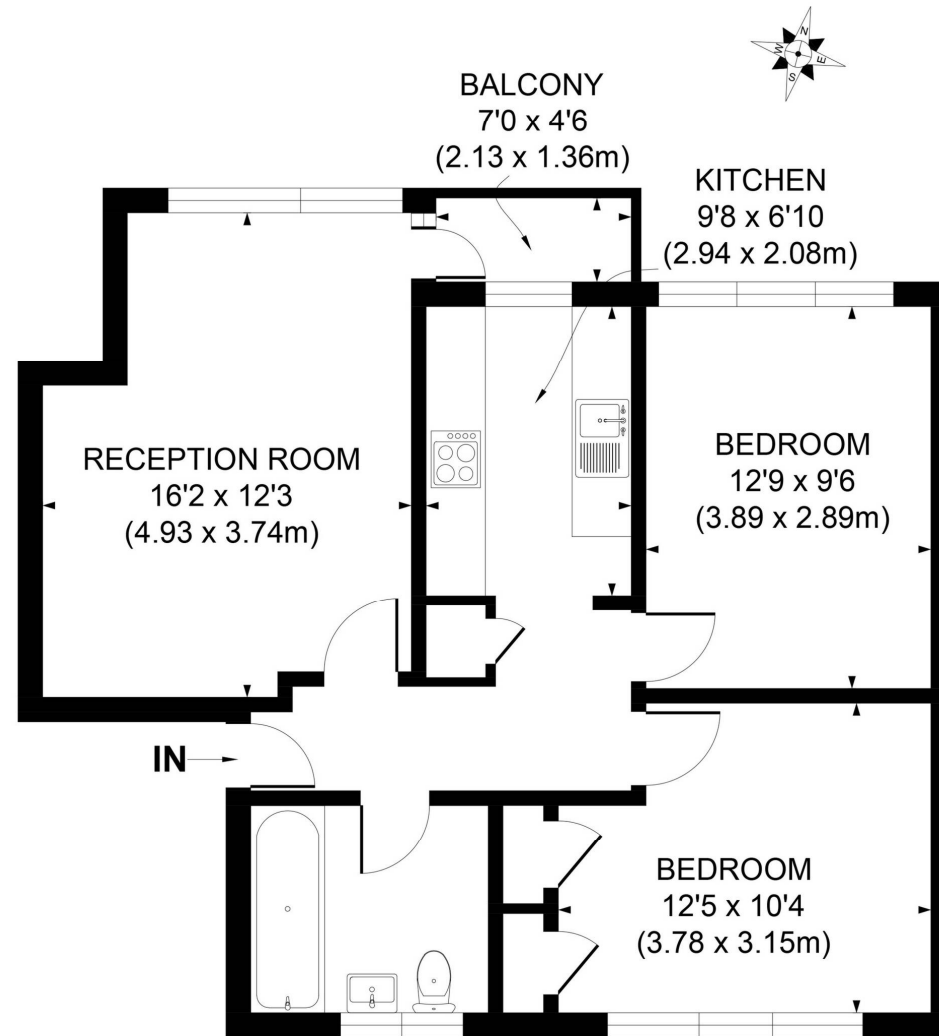

APPROX. GROSS INTERNAL FLOOR AREA 646 SQ. FT/60.05 SQ. M

Illustration for identification purpose only, not to scale
All measurements are maximum, and includes wardrobes and window bays where applicable
Prepared by Pixangle ©. Tel 020 8870 2118

Weydown Close, Southfields, London, SW19

For Sale: £350,000



Seymour Green, 483 Merton Road, London SW18 5LE
T: 020 8870 0111 F: 020 3302 9598 E: southfields@seymour-green.co.uk W: seymour-green.co.uk



SEYMOURGREEN

AT THE HEART ♥ OF YOUR MOVE

Weydown Close, Southfields, London, SW19

For Sale: £350,000

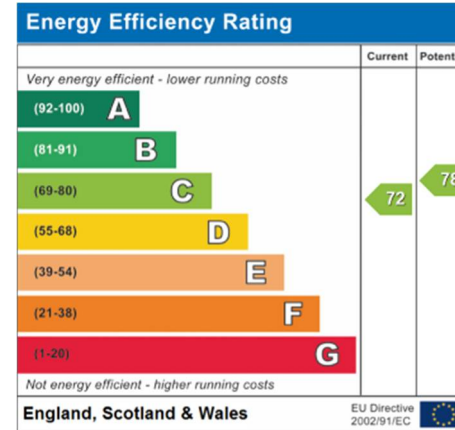
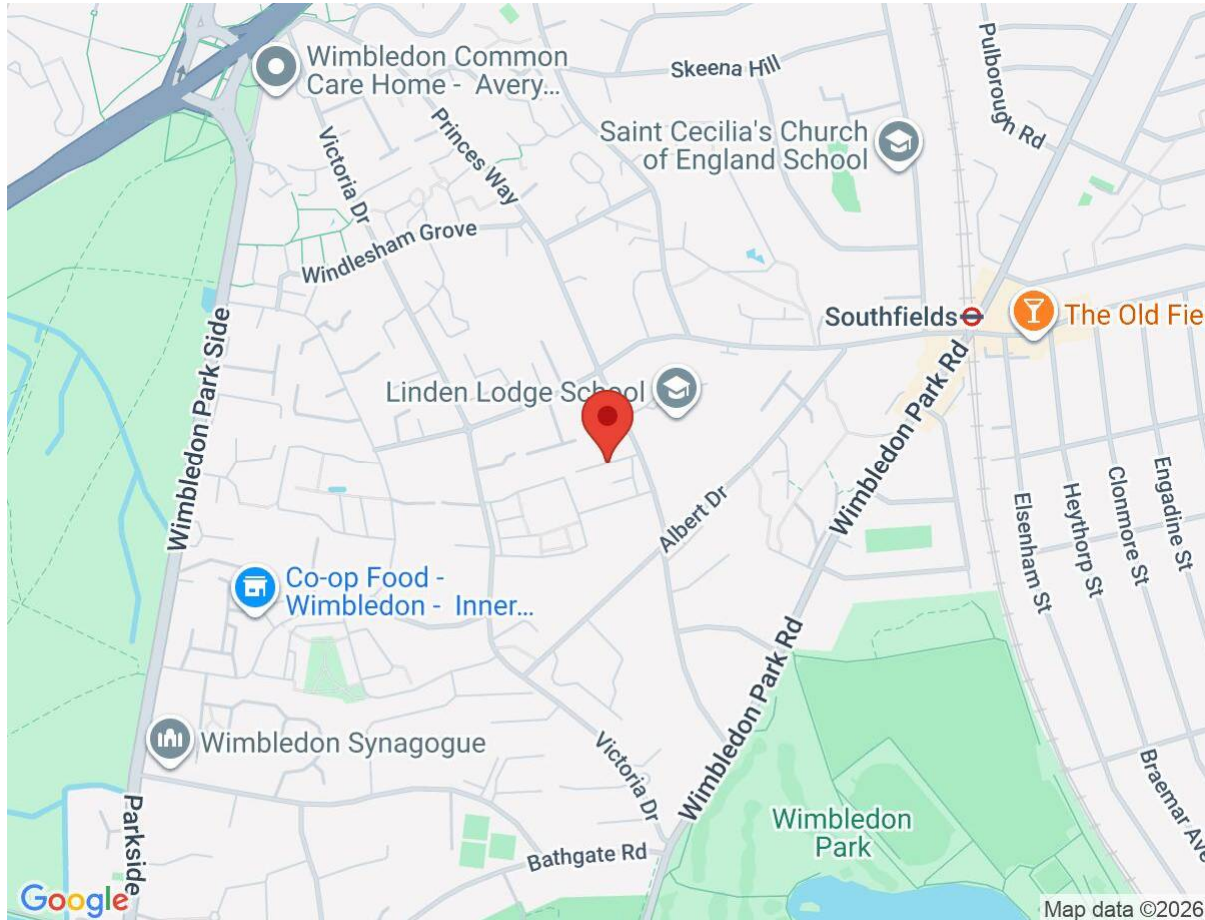

IMPORTANT NOTICE
Descriptions of the property are subjective and are used in good faith as an opinion and NOT as a statement of fact. Please make further specific enquires to ensure that our descriptions are likely to match any expectations you may have of the property. We have not tested any services, systems or appliances at this property. We strongly recommend that all the information we provide be verified by you on inspection, and by your Surveyor and Conveyancer.

Seymour Green, 483 Merton Road, London SW18 5LE
T: 020 8870 0111 F: 020 3302 9598 E: southfields@seymour-green.co.uk W: seymour-green.co.uk