



SEYMOURGREEN
AT THE HEART ♥ OF YOUR MOVE

Glenbuck Road, Surbiton, Surrey, KT6

- ♥ Top Floor with Lift
- ♥ 171 Year Lease
- ♥ In Need of Cosmetic Updating
- ♥ Allocated Parking Space
- ♥ No Onward Chain
- ♥ Great Location

A very spacious top floor- with lift- two double bedroom flat just a few minutes' walk from Surbiton Mainline Station (Waterloo in 15 Minutes). The property does require some cosmetic updating so affords the incoming purchaser the opportunity to make their own mark. With two double bedrooms, large living dining room, fitted kitchen and bathroom, balcony and allocated off street parking space located in the heart of Surbiton this property does represent a fantastic opportunity for first time buyers or investors.

For Sale: £375,000



Seymour Green, 483 Merton Road, London SW18 5LE

T: 020 8870 0111 F: 020 3302 9598 E: southfields@seymour-green.co.uk W: seymour-green.co.uk



SEYMOURGREEN

AT THE HEART ♥ OF YOUR MOVE

GLENBUCK ROAD, KT6

Approx. Gross Internal Floor Area

773 Sq. ft/71.83 Sq. m

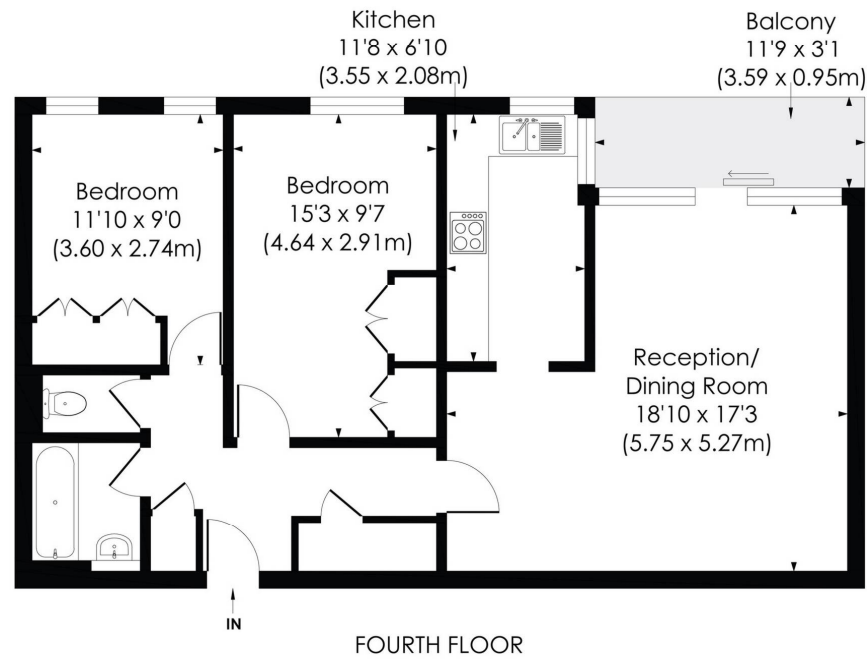

© Pixangle Property Marketing Ltd. info@pixangle.com Tel: 0208 870 2118

pixangle
PROPERTY MARKETING

This floor plan has been prepared for the purpose of illustration only in accordance with the latest RICS code of measuring practice and is not to scale. All measurements and areas are approximate and whilst every effort has been made to ensure the accuracy of the plan contained here, no responsibility is taken for any error, omission or misstatement.

Glenbuck Road, Surbiton, Surrey, KT6

For Sale: £375,000



Seymour Green, 483 Merton Road, London SW18 5LE
T: 020 8870 0111 F: 020 3302 9598 E: southfields@seymour-green.co.uk W: seymour-green.co.uk



SEYMOURGREEN

AT THE HEART ♥ OF YOUR MOVE

Glenbuck Road, Surbiton, Surrey, KT6

For Sale: £375,000

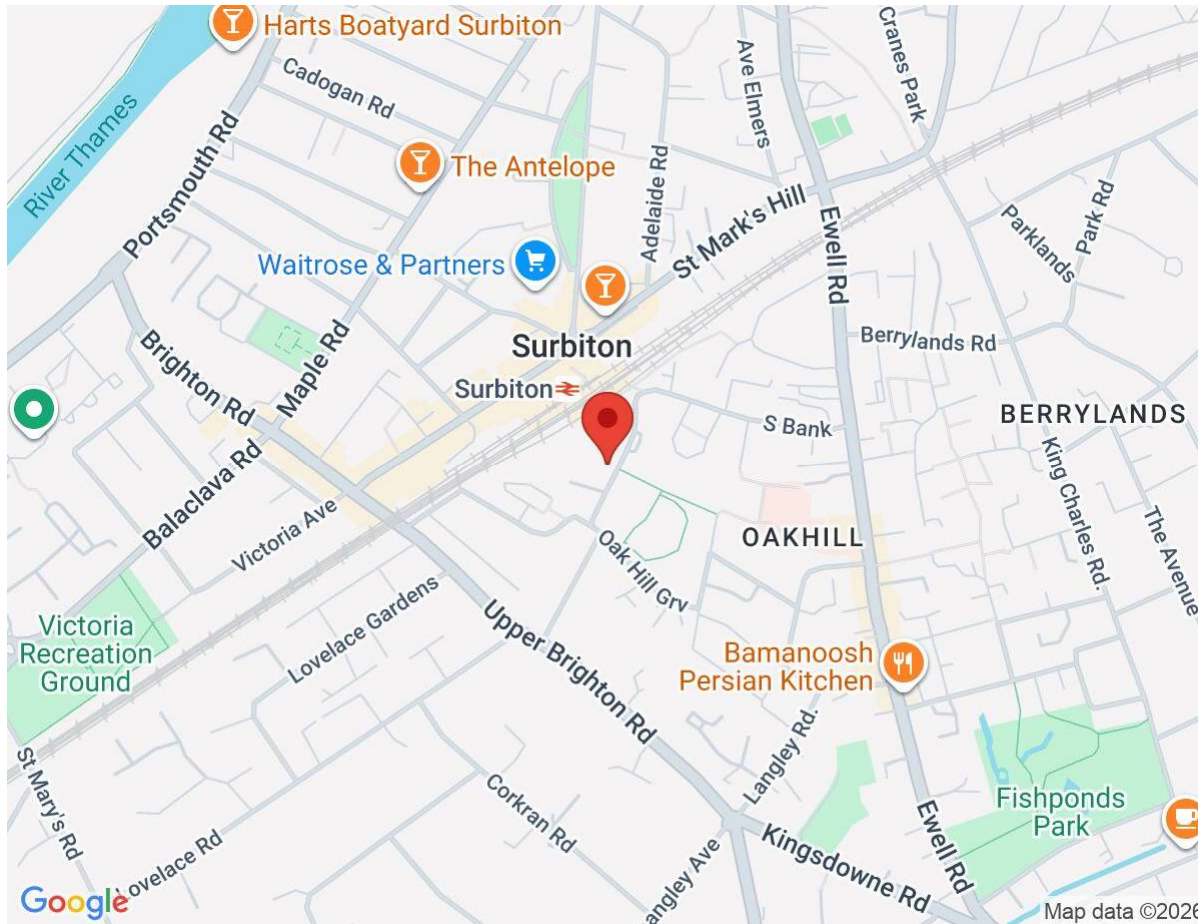

IMPORTANT NOTICE

Descriptions of the property are subjective and are used in good faith as an opinion and NOT as a statement of fact. Please make further specific enquires to ensure that our descriptions are likely to match any expectations you may have of the property. We have not tested any services, systems or appliances at this property. We strongly recommend that all the information we provide be verified by you on inspection, and by your Surveyor and Conveyancer.

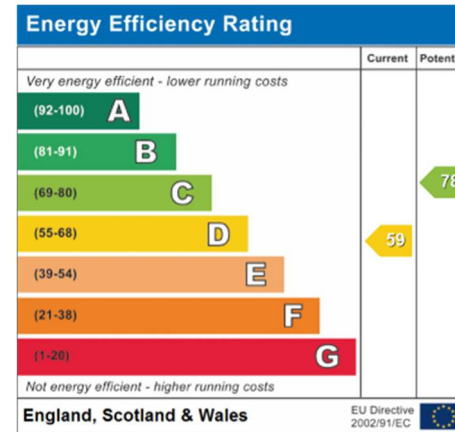

Seymour Green, 483 Merton Road, London SW18 5LE

T: 020 8870 0111 F: 020 3302 9598 E: southfields@seymour-green.co.uk W: seymour-green.co.uk