



£360,000 Leasehold

MAYBURY COURT, PITSHANGER LANE, EALING, W5 1RU





A SPACIOUS ONE-BEDROOM GROUND FLOOR APARTMENT IN THE HEART OF PITSHANGER VILLAGE.

Ideally placed on the award winning Pitshanger Lane with its interesting array of shops, restaurants, and facilities, Pitshanger Park with its vast open spaces is close by. Well served by regular bus routes to Ealing Broadway Town Centre and Station - enjoying all the benefits of Elizabeth, Central and District Lines.

This attractive ground floor apartment is offered in very good condition and comprises: Spacious living room with direct access to a communal garden. Fitted kitchen. Double bedroom. Shower room. Benefiting from double glazing throughout. No forward chain.

Lease: 999 Years from 25th March 2006

Service Charge: £2,091.88 P/A

COUNCIL TAX BAND: C

EPC Rating: E



www.sintonandrews.com
020 8566 1990

Maybury Court

Approximate Gross Internal Area = 53.6 sq m / 576 sq ft

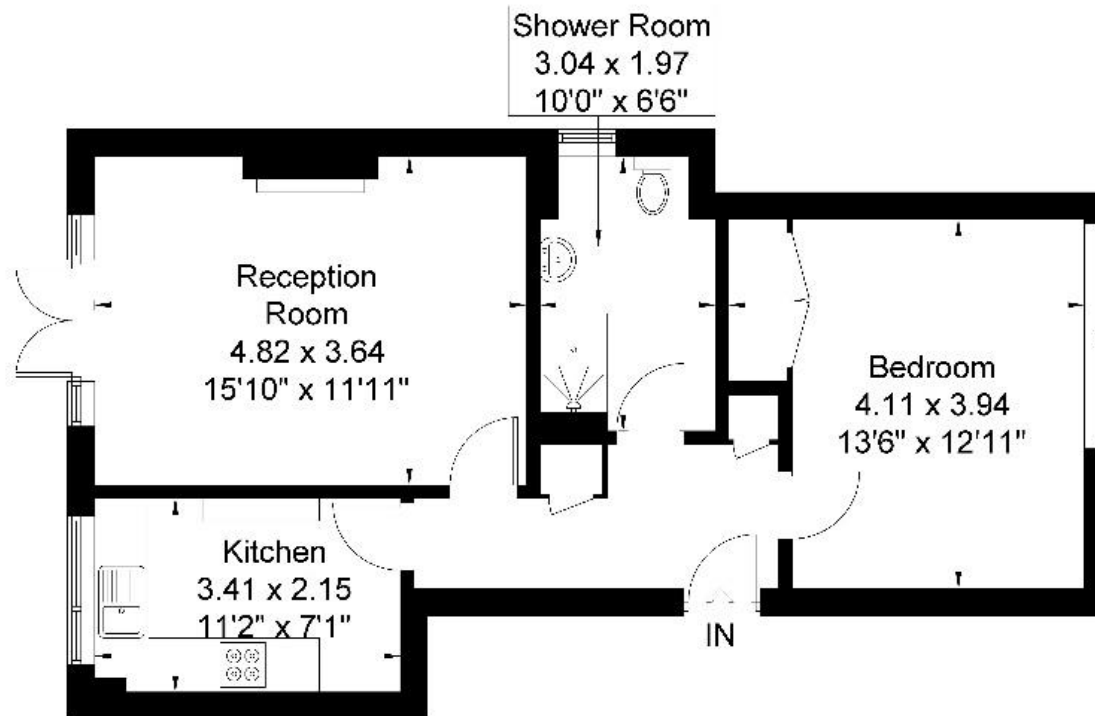
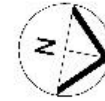

Ground Floor

Although every attempt has been made to ensure accuracy, all measurements are approximate.

The floorplan is for illustrative purposes only and not to scale.

© www.perspective.co.uk

020 8566 1990

8 Spring Bridge Road, Ealing, London W5 2AA

SINTONANDREWS.COM

