



VIA PROPERTIES



High Street |
Hoddesdon | EN11

VIA Properties are pleased to offer this two bedroom apartment located in Hoddesdon Town centre

Courtyard terrace area | Town Centre location | Two double bedrooms | Open plan living / kitchen area | Close to Rye House & Broxbourne train stations | Storage cupboard

Asking price of £1,275 per month

VIA Properties are pleased to offer this two bedroom apartment located in Hoddesdon Town centre

THE PROPERTY COMPRISES OF

Open plan kitchen / living area

Master bedroom with large wardrobe

Large second bedroom with storage cupboard

Luxury bathroom with bath and shower combination

Also, the property has a good sized courtyard terrace area accessed via double doors in the living room

THE LOCATION:

A modern apartment block located in Hoddesdon Town. This development is located just off the main thoroughfare of Hoddesdon High Street, yet within easy reach of all the shops and amenities the town has to offer.

Commuters will be pleased to know that Broxbourne Train Station is around 10-15 minutes' walk from the



apartment. Broxbourne Station offers a direct service into London Liverpool Street, Tottenham Hale and Stratford. Rye House train station is also very close by.

FURTHER DETAILS:

Tenants are responsible for the following:

- Council tax
- Electricity usage
- Gas usage
- Water usage



GROUND FLOOR
553 sq.ft. (51.4 sq.m.) approx.

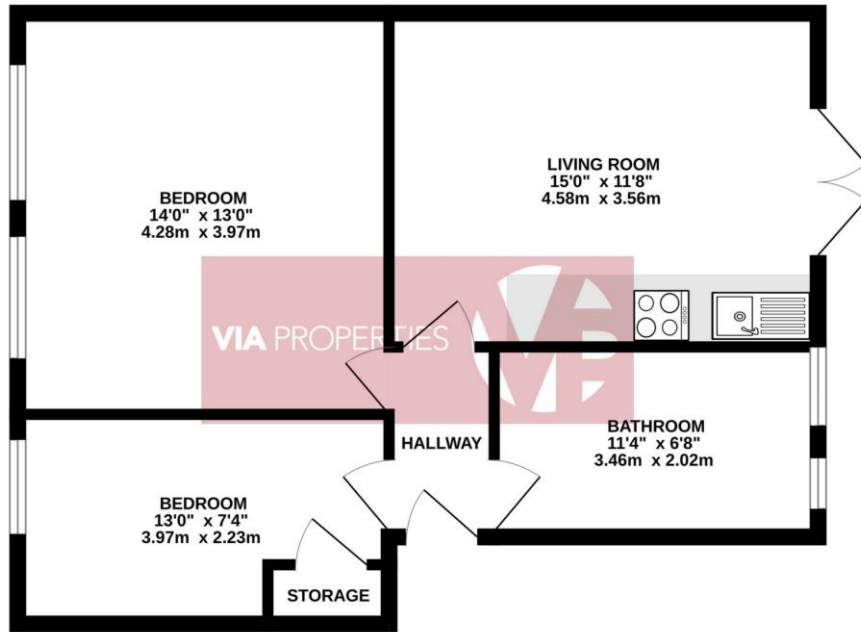

TOTAL FLOOR AREA: 553 sq.ft. (51.4 sq.m.) approx.
Whilst every attempt has been made to ensure the accuracy of the floorplan contained here, measurements of doors, windows, rooms and any other items are approximate and no responsibility is taken for any error, omission or mis-statement. This plan is for illustrative purposes only and should be used as such by any prospective purchaser. The services, systems and appliances shown have not been tested and no guarantee as to their operability or efficiency can be given.
Made with Metropix ©2023

VIA PROPERTIES

74 High Street, Hoddesdon, EN11
01992443399 | info@viavia.co.uk | www.viavia.co.uk

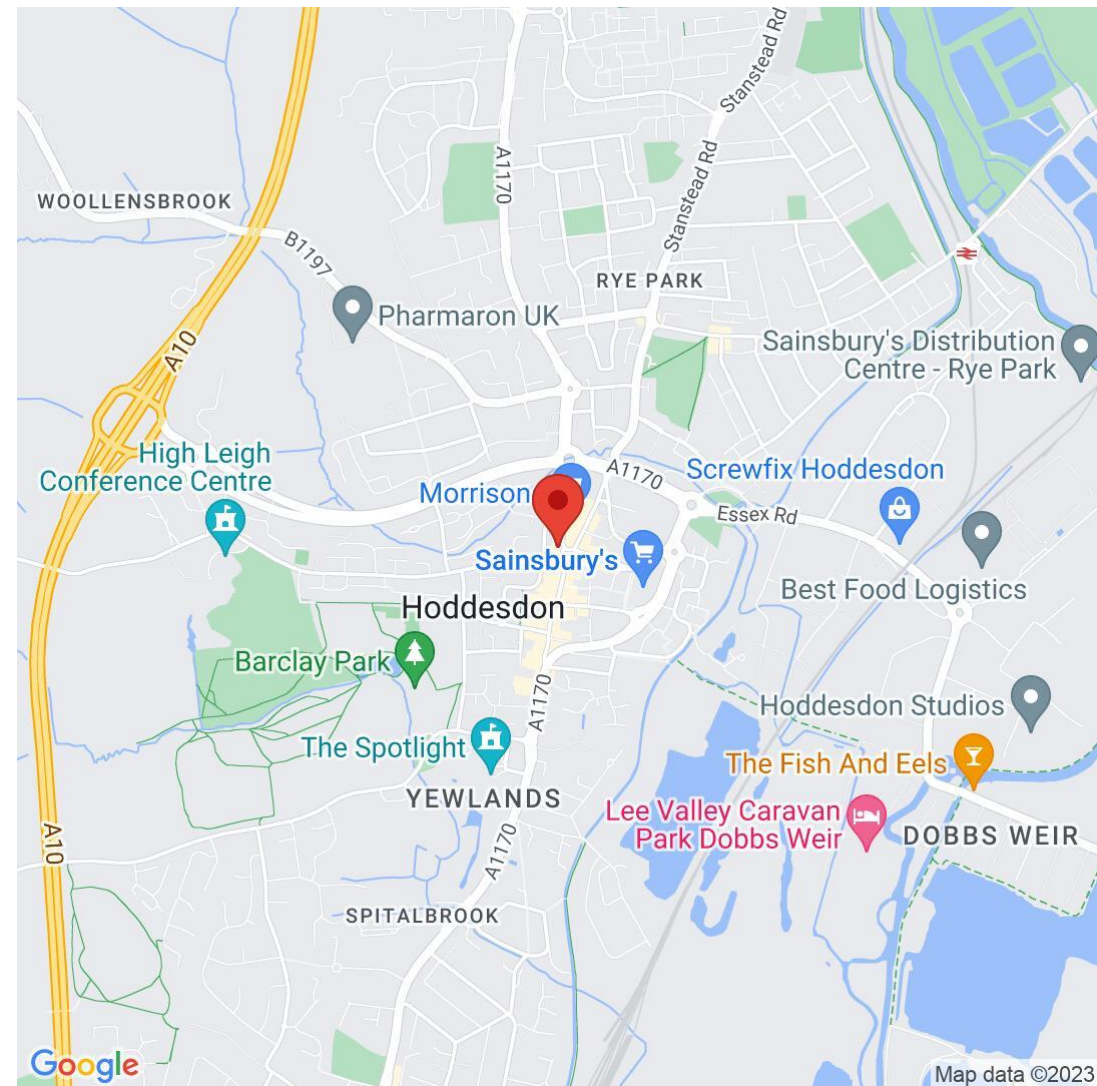

Important Notice - These particulars have been prepared in good faith and they are not intended to constitute part of an offer or contract. We have not performed a structural survey on this property and the services, appliances and specific fittings have not been tested. All photographs, measurements, floor plans and distances referred to are given as a guide and should not be relied upon.