



VIA PROPERTIES



Parrotts Field |
Hoddesdon | EN11

VIA Properties are delighted to offer this first floor flat on the very popular Parrotts Field Development

First floor | Electric storage heaters | Short walk from Rye House Train Station | Ample parking | Built in wardrobe in bedroom | Bathroom with bath and shower combination

Asking price of £850 per month

VIA Properties are delighted to offer this first floor flat on the very popular Parrotts Field Development **The Opportunity:** There is kitchen with white goods included, a large living area and bedroom with built in wardrobe. The bathroom is of a good size and has a shower over the bath. The entrance hallway has a storage cupboard. The development boasts ample parking, additionally there is pedestrian access to the town centre. **The Location:** A short walk to Rye House Train Station / 5 minute drive to Broxbourne station A short walk from Hoddesdon town centre Convenient for the A10 / A414 and many local shops **Visit us or email us at:** Please call for further details or to arrange a viewing **Lets be Social::**
facebook.com/VIA.Properties.Estate.Agents
instagram.com/via.properties/
twitter.com/PropertiesByVia 74 High Street, Hoddesdon, Hertfordshire, EN11 8ET





FIRST FLOOR
322 sq.ft. (29.9 sq.m.) approx.

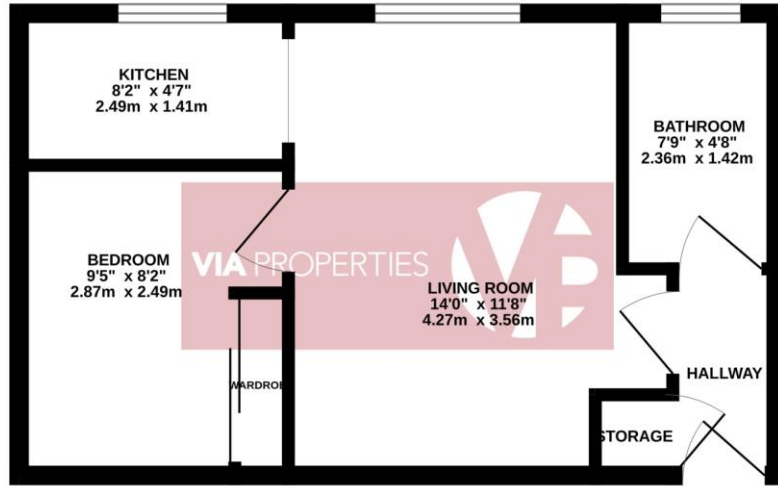

TOTAL FLOOR AREA : 322 sq.ft. (29.9 sq.m.) approx.
Whilst every attempt has been made to ensure the accuracy of the floorplan contained herein, measurements of doors, windows, rooms and any other items are approximate and no responsibility is taken for any error, omission or mis-statement. This plan is for illustrative purposes only and should be used as such by any prospective purchaser. The services, systems and appliances shown have not been tested and no guarantee as to their operability or efficiency can be given.
Made with Meeqaq ©2024

VIA PROPERTIES
74 High Street, Hoddesdon, EN11
01992443399 | info@viavia.co.uk | www.viavia.co.uk

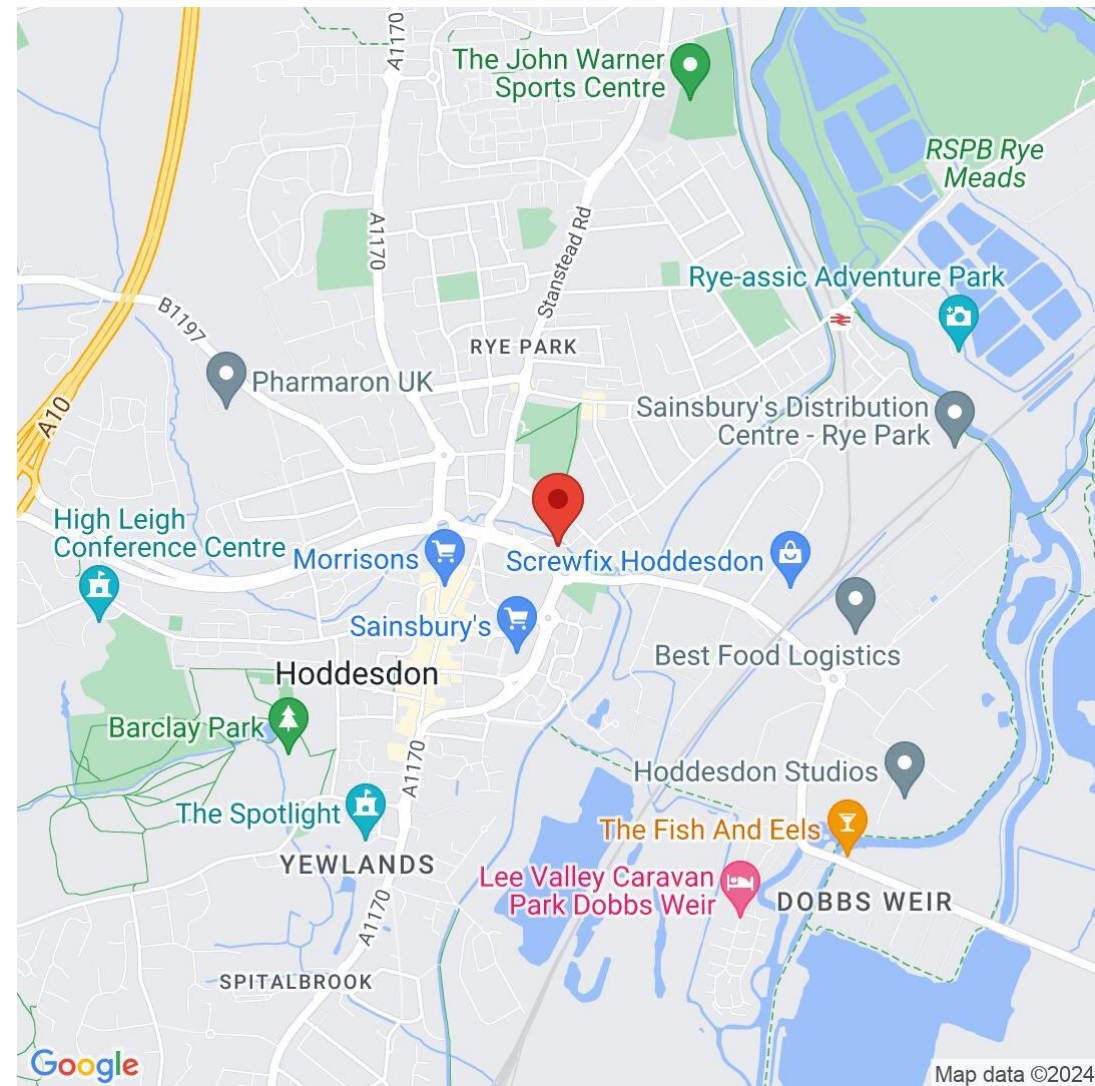

Important Notice - These particulars have been prepared in good faith and they are not intended to constitute part of an offer or contract. We have not performed a structural survey on this property and the services, appliances and specific fittings have not been tested. All photographs, measurements, floor plans and distances referred to are given as a guide and should not be relied upon.